

TRANSPORTATION

EQUIPMENT SELECTION GUIDE

DEVILBISS

Ransburg

BGK

BINKS



finishingbrands.com

TABLE OF CONTENTS

Overview.....	2-3
Atomization: Manual.....	4-8
Atomization: Automatic.....	9-11
Fluid Delivery: Pumps.....	12-16
Fluid Delivery: Accessories.....	17
Fluid Delivery: Tanks & Cups.....	18-20
Fluid Delivery: Disposable Cups.....	21
Fluid Delivery: 2K Mixing.....	22-24
Fluid Delivery: System Components.....	25
Curing: Infrared.....	26-27
Air Controls: Filter, Regulator, Coalescer.....	28
Hose & Connections: Air, Fluid.....	29-30
Accessories & Maintenance: Spray Guns.....	31

Find Your Solutions

Customer Support and Technical Assistance

800-992-4657 Call Toll Free (USA/Canada)

888-246-5732 Fax Toll Free (USA/Canada)

MSDS and more info online

bgk.com

binks.com

devilbiss.com

ransburg.com

finishingbrands.com

Ask Us About



Seeing Is Believing
ONSITE DEMO/TRIAL PROGRAM

Selecting The Right Equipment



It's Critical to Use the Right Equipment for Each Application

Using the right equipment for each step of any spray finishing process is typically the difference between hitting quality, productivity and profitability targets – and not hitting them. Additionally, the ever increasing diversity of coatings dictate careful selection and proper use of equipment.

With nearly 350 years of collective leadership in the spray finishing and curing industries, Binks, DeVilbiss, Ransburg and BGK continue to set the equipment standards other brands strive to achieve. Regardless of project type, new and varied coating materials, or other special requirements, Finishing Brands are dedicated to supporting you with a team of experts – Finishing Specialists, Equipment Design Engineers, Technicians, Trainers and Customer Service Professionals.

We're here to help you improve every aspect of your spray finishing operation – Higher Quality, Increased Productivity, New Cost-Efficiencies, Reduced Downtime, Environmental Compliance... and Improved Bottom-Line Results.



ATOMIZATION TECHNOLOGY OPTIONS

Types of Atomization Technology: Conventional, HVLP, LVMP, Air-Assisted Airless, Airless and Electrostatic. Each has different operating parameters, outlined in brief below.

Conventional The most established method of air atomizing, used on spray guns for decades. This type uses high velocity air jets to produce a high atomization power which is very effective in breaking up high solids and high viscosity coatings. Air pressure exiting the air cap during use is typically 40-70 psi (2 to 5 bar) with typical air consumption of 6 to 25 cfm (170 to 700 l/min).

High Volume Low Pressure (HVLP) HVLP uses higher volumes of air (11 to 30 cfm or 300 to 840 l/min) at low pressure (psi) to atomize the coating. HVLP provides high transfer efficiency and is limited by Government Environmental Legislation to a maximum of 10 psi (0.7 bar) atomizing pressure measured at the air cap.

Low Volume Medium Pressure (LVMP) LVMP makes more energy available for the atomization process than HVLP, but delivers transfer efficiencies equivalent to those of HVLP. Air cap pressure is typically in the area of 20 to 45 psi (1.3 to 3 bar) while using 9 to 20 cfm (250 to 560 l/min) for atomization of coatings.

Air-Assisted Airless To maximize efficiency, the best features of air spray and airless atomization are combined in this technology. The pattern is formed by the spray tip at between 500 and 2,500 psi fluid pressure and a small amount of air pressure is used to adjust the size of the spray pattern and eliminate "tails". Air-Assisted Airless provides fast application of materials, a soft spray that reduces fog overspray and bounce-back, and the ability to penetrate into recesses and cavities. This is especially important where intricate shapes require a consistent film build.

Airless Fluid is atomized by high pressure (usually 3,000 – 7,000 psi) and pushed through an orifice in the spray tip which is typically .015" - .035" in diameter. The shape of the orifice determines the shape and size of the spray pattern. With airless technology, the size of the atomized particle is larger than other spray methods and therefore typically not used for achieving fine finishes.

Electrostatic Electrostatic spray finishing combines the mechanical process of atomization with the distributive effects of electrical attraction and repulsion to achieve a highly efficient product finishing operation.

Atomization is achieved in liquid systems by air, airless, air-assisted airless or rotary apparatus. The atomized droplets of coating material are put through a highly ionized zone where the coating particles pick up a charge. Particles are similarly charged, and like charges repel one another causing the particles to form a larger, more evenly distributed spray pattern than a non-electrostatic pattern.

The charged paint particles are drawn toward the grounded object being painted. The paint particles have a negative charge and are attracted to the positive ground of the product being coated.

FLUID DELIVERY OPTIONS

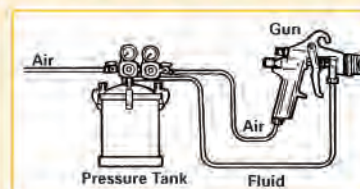

Pressure Feed This option uses an external pressure source (pressure tank, piston pump, or diaphragm pump) to push fluid to the spray gun nozzle. Air and fluid are then mixed outside the nozzle to atomize the coating.

Advantages: This method delivers higher volumes of fluids than siphon and gravity feed set-ups, and will spray a wider range of materials. It also enables independent control of fluid and air pressure.

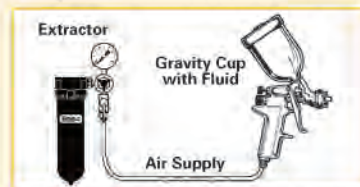

Gravity Feed On gravity feed guns the cup is located above the gun. The force of gravity pushes the fluid into the gun.

Advantages: This method offers quick color changes and convenience on small jobs or touch up applications. Gravity guns are able to use all of the coating – reducing waste.



Siphon Feed Siphon feed hookups use vacuum created at the nozzle to draw fluid from a cup.

Advantages: This fluid cup system offers quick material / color changes, easy clean-up on smaller jobs.

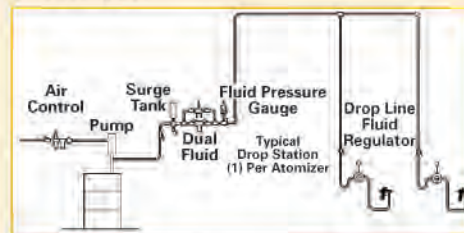

Supply Pump This type of pump system will take a barrel of coating and push the fluid through to paint guns.

Advantages: This method provides higher volumes of fluid and can supply more than a single painter.

Ransburg Ransflex *Manual Electrostatic Spray Guns*



NEW Ransburg RansFlex® Advanced Series Ransburg Electrostatic+DeVilbiss Atomization

High Performance Finishing. Made in USA.

Combines Ransburg electrostatics with DeVilbiss atomization to produce one of the best atomizing, most efficient electrostatic spray guns available.

Smaller, lighter weight Ransflex RX and RFX applicators feature enhanced proprietary cascade and atomization technology. These advancements provide a compact applicator with better performance and transfer efficiency compared to similar voltage competitive guns.



Ransflex Delivers:

- Superior atomization and performance at lower inlet pressures
- Ergonomic fit, feel, and balance with simple to use controls
- Fluid nozzles of different sizes are color coded to allow for easy recognition
- Sleek and smooth exterior for easy cleaning and maintenance
- Patented turbine utilizes a 3 phase motor to reduce gun vibration
- Quick disconnect built into gun to reduce torque stress on operator's wrist
- Internal power supply reduces the number of lines to the gun
- 20% reduction in parts – new modularized parts
- Rugged design backed by a 5 year limited warranty
- Conventional and LVMP air caps available
- Air and fluid hoses can be ordered in 10m, 15m, 20m and 30m lengths



	RansFlex RX Lower kV gun model	RansFlex RFX Higher kV gun model
Weight Without Hoses	599g (21.3 oz.)	620g (22.0 oz.)
Height	190.5 mm (7.5")	190.5 mm (7.5")
Width Max.	41.2 mm (1 5/8")	41.2 mm (1 5/8")
Length	254 mm (10")	273 mm (10 3/4")
Operating Voltage	45 kV	65 kV
Max. Current	140 mA	120 mA
Min. Inlet Pressure	2.8 bar (40 psig) (dynamic at handle inlet)	2.8 bar (40 psig) (dynamic at handle inlet)
Paint Conductivity	.1 M to infinity	.1 M to infinity
Fluid Flow Capacity	1,000 ml/min.*	1,000 ml/min.*
Consumption With Voltage	4385 lpm (15.4 scfm) 2.8 bar (40 psig) (at handle inlet)	4385 lpm (15.4 scfm) 2.8 bar (40 psig) (at handle inlet)
Material	Solvent Base	Solvent Base

* Depends on material viscosity and tip size selected

Binks Trophy™ Low Pressure Spray Guns

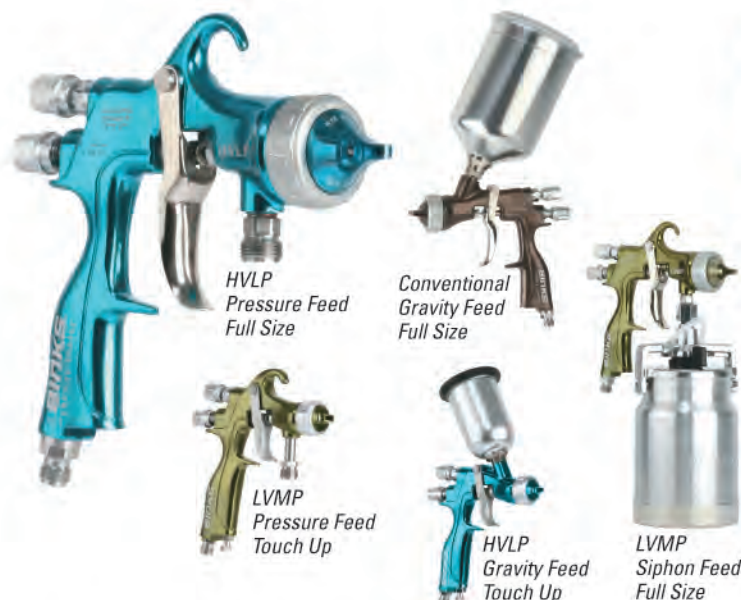

Application Versatility:

- **Sizes:** Full size and touch up
- **Spray Technologies:** HVLP, LVMP (Compliant), Conventional
- **Gun Body Colors:** Blue (HVLP) / green (LVMP) / brown (Conventional)
- **Fluid Nozzles and Needle Set-Ups:** Tuff tip hardened stainless steel nozzles, tungsten carbide, plastic tip needles, and feathering needles
- Available in pressure feed, gravity feed, and siphon feed

Ergonomic Design:

- Lightweight
- Curved handle for increased comfort
- Oversized knobs and air cap ring for easy adjustments and maintenance
- Soft trigger pull for reduced stress and fatigue
- Smooth trigger pull for providing no-kickback during spraying

Robust Engineering:

- Large stainless steel fluid passages for compatibility with industrial coatings
- Long lasting brass inserts and seals
- Hardened stainless steel fluid nozzles
- Large air passages
- Anodized forged aluminum gun body provides durability

Part No.	Gun Body	Brand	Model	Technology	Material Compatibility	Material Feed	CFM @ 30 psi	Max. Pattern Size (in)	Fluid Nozzle	Fluid Nozzle (mm / in)	Air Nozzle	Fluid Needle Material
2466-14LV-23SG	Full Size	Binks	Trophy	LVMP	Thin/Medium	G	10.6	10	14	1.4/.055	23L	SS
2466-14HV-32SG	Full Size	Binks	Trophy	HVLP	Thin/Medium	G	15.5	10	14	1.4/.055	32H	SS
2465-14CN-11S0	Full Size	Binks	Trophy	Conventional	Thin/Medium	p	12.1*	12	14	1.4/.055	11C	SS
2465-16CN-12S0	Full Size	Binks	Trophy	Conventional	Thin/Med/Heavy	S/P	8	12	16	1.6/.063	12C	SS
2465-10LV-25S0	Full Size	Binks	Trophy	LVMP	Thin/Medium	P	13	11-13	10	1.0/.040	25L	SS
2465-14LV-25S0	Full Size	Binks	Trophy	LVMP	Thin/Medium	P	13	11-13	14	1.4/.055	25L	SS
2465-12HV-32S0	Full Size	Binks	Trophy	HVLP	Thin/Medium	P	16	14	12	1.2/.047	32H	SS
2465-14HV-32S0	Full Size	Binks	Trophy	HVLP	Thin/Medium	P	16	16	14	1.4/.055	32H	SS
2465-10HV-39S0	Full Size	Binks	Trophy	HVLP	Thin/Medium	P	8.75**	16	10	1.0/.040	39H	SS
2465-12HV-39S0	Full Size	Binks	Trophy	HVLP	Thin/Medium	P	8.75**	16	12	1.2/.047	39H	SS
2465-14HV-39S0	Full Size	Binks	Trophy	HVLP	Thin/Medium	P	8.75**	16	14	1.4/.055	39H	SS
1466-10LV-B1S	Touch Up	Binks	Trophy	LVMP	Thin/Medium	G	7.8	7	10	1.0/.040	B1	SS
1466-12LV-B1S	Touch Up	Binks	Trophy	LVMP	Thin/Medium	G	7.8	7	12	1.2/.047	B1	SS
1466-10LV-C1S	Touch Up	Binks	Trophy	HVLP	Thin/Medium	G	8	5-7	10	1.0/.040	C1	SS
1466-12LV-C1S	Touch Up	Binks	Trophy	HVLP	Thin/Medium	G	8	5-7	12	1.2/.047	C1	SS
1465-12HV-C1S	Touch Up	Binks	Trophy	HVLP	Thin/Medium	P	8	7	12	1.2/.047	C1	SS

Notes: * CFM at 50 psi
** CFM at 14 psi

S Siphon Feed
P Pressure Feed
G Gravity Feed

Compact™ & Finishline™ Spray Guns



DeVilbiss Compact Spray Guns

- Mid-sized high production guns in HVLP, LVMP, and Conventional technologies
- Superior finish with extremely high transfer rates
- Available in gravity, siphon and pressure feed
- Plated brass air caps for durability
- Wide selection of stainless steel tips from .020" (.50mm) to .086" (2.2mm)
- Mini Touch Up available in gravity feed

DeVilbiss Finishline Spray Guns

Economical HVLP/Conventional guns with proven performance.

- Easy to clean blue anodized finish
- High grade stainless steel parts
- Available in gravity, siphon, and pressure feed
- Siphon and gravity models come with DeKups* disposable cups (see page 21)

Part No.	Gun Body	Brand	Model	Technology	Material Feed	CFM @ 30 psi	Max. Pattern Size (in)	Fluid Nozzle	Fluid Nozzle (mm / in)	Air Nozzle	Fluid Needle Material
COM-GS507B-14-02	Full Size	DeVilbiss	Compact	HVLP	G	17.3	15	14	1.4/.055	507	SS
COM-G510G-14-02	Full Size	DeVilbiss	Compact	Trans-Tech	G	10	11	14	1.4/.055	510	SS
COM-G513G-14-02	Full Size	DeVilbiss	Compact	Trans-Tech	G	14	14	14	1.4/.055	513	SS
COM-G513G-18-02	Full Size	DeVilbiss	Compact	Trans-Tech	G	14	14	18	1.8/.070	513	SS
COM-G430-14-02	Full Size	DeVilbiss	Compact	Conventional	G	12	8	14	1.4/.055	430	SS
COM-PS507B-10-00	Full Size	DeVilbiss	Compact	HVLP	P	18	15	10	1.0/.039	507	SS
COM-PS507B-14-00	Full Size	DeVilbiss	Compact	HVLP	P	18	15	14	1.4/.055	507	SS
COM-PS510G-10-00	Full Size	DeVilbiss	Compact	Trans-Tech	P	10	10	10	1.0/.039	510	SS
COM-PS510G-14-00	Full Size	DeVilbiss	Compact	Trans-Tech	P	10	10	14	1.4/.055	510	SS
COM-PS510G-18-01	Full Size	DeVilbiss	Compact	Trans-Tech	S/P	10	10	18	1.8/.070	510	SS
COM-PS513G-10-00	Full Size	DeVilbiss	Compact	Trans-Tech	p	14	14	10	1.0/.039	513	SS
COM-PS513G-14-00	Full Size	DeVilbiss	Compact	Trans-Tech	P	14	14	14	1.4/.055	513	SS
COM-PS522G-10-00	Full Size	DeVilbiss	Compact	Trans-Tech	P	14	14	10	1.0/.039	522	SS
COM-PS522G-14-00	Full Size	DeVilbiss	Compact	Trans-Tech	P	14	14	14	1.4/.055	522	SS
COMM-HS1-10	Touch Up	DeVilbiss	Compact Mini	HVLP	G	5	9	10	1.0/.039	HS1	SS
COMM-HS1-12	Touch Up	DeVilbiss	Compact Mini	HVLP	G	5	9	12	1.2/.047	HS1	SS
COMM-TS1-10	Touch Up	DeVilbiss	Compact Mini	Trans-Tech	G	4	9	10	1.0/.039	TS1	SS
COMM-TS1-12	Touch Up	DeVilbiss	Compact Mini	Trans-Tech	G	4	9	12	1.2/.047	TS1	SS
FLG-HVS-322	Full Size	DeVilbiss	FLG	HVLP	S	13	10.5	22	2.2/.086	3	SS
FLG-CNS-115	Full Size	DeVilbiss	FLG	Conventional	S	9.9	10.5	15	1.5/.059	1	SS
FLG-HVP-315	Full Size	DeVilbiss	FLG	HVLP	P	13	10.5	15	1.5/.059	3	SS
FLG-HVG-315	Full Size	DeVilbiss	FLG	HVLP	G	13	10.5	15	1.5/.059	3	SS
FLG-CNG-115	Full Size	DeVilbiss	FLG	Conventional	G	9.9	10.5	15	1.5/.059	1	SS

Other air caps and fluid tips are available for the Compact guns

*U.S. Patent Nos. 6,820,824 and 7,374,111 owned by 3M Innovative Properties Co. Additional U.S. Patents: Nos. 7,353,964; 7,344,040; 7,086,549.



Low Pressure *Spray Guns*

DeVilbiss Model JGA & JGHV Spray Guns

The JGA standard-size manual spray gun is extremely versatile and rugged. The JGA sets the industry standard for high production performance. The JGHV has all of the great features of the JGA with the added benefit of being HVLP Compliant.

Features & Benefits:

- Plated-brass air caps
- Stainless steel fluid nozzles and needles
- Stainless steel fluid passages for complete material compatibility
- Comfortable "fit and feel" handle design

Viscosity Range: Low to high

Typical Industrial Coatings: Primers, epoxies, urethanes, enamels, adhesives, abrasives, textured coatings, high solids, and zinc rich materials



DeVilbiss Model EGA & EGHV Touch Up Guns

The EGA is the spray gun of choice for touch up, shading and detail decorating. This conventional touch up gun provides precise control for any type of delicate spray finishing applications. EGHV has all the features of the EGA and is HVLP compliant.

Features & Benefits:

- Stainless steel tip and needle
- Forefinger trigger to enhance operator control
- Long needle taper to make detail work easy

Typical Industrial Coatings: Water based paints, enamels, urethanes, stains and varnishes, inks and dyes, and lacquers



Binks Model 2100 Conventional Spray Gun

The Binks Model 2100 is a full sized high production gun. Designed and built with the professional finisher in mind, the 2100 gun will handle virtually all industrial and protective coatings.

Features & Benefits:

- Wide selection of air nozzles and stainless steel fluid nozzles and needles
- All stainless steel fluid passages for complete material compatibility

Viscosity Range: Low to high

Typical Industrial Coatings: Lacquers, primers, epoxies, urethanes, enamels, adhesives, abrasives, textured coatings, non-stick coatings, high solids, and zinc rich materials



Binks Model 115 Touch Up Gun

The Model 115 is a conventional spray gun designed for touch up, shading, and spotting jobs.

Features & Benefits:

- Plated brass air caps
- Stainless steel fluid nozzles and needles
- Rugged forged aluminum body with butterfly trigger

Typical Industrial Coatings: Solvent and water based paints, stains and varnishes, inks and dyes, and lacquers



Part No.	Gun Body	Brand	Model	Technology	Material Compatibility	Material Feed	CFM @ 30 psi	Max. Pattern Size (in)	Fluid Nozzle	Fluid Nozzle (mm / in)	Air Nozzle	Fluid Needle Material
JGA-510-704FX	Full Size	DeVilbiss	JGA	Conv	Light - Medium	P	18**	10 - 12	FX	1.1/.042	704	SS ^{AA}
JGA-510-704FF	Full Size	DeVilbiss	JGA	Conv	Medium - Heavy	P	18**	10 - 12	FF	1.4/.055	704	SS ^{AA}
JGA-510-704E	Full Size	DeVilbiss	JGA	Conv	Medium - Heavy	P	18**	10 - 12	E	1.8/.070	704	SS ^{AA}
JGA-510-765FX	Full Size	DeVilbiss	JGA	Conv	Light - Medium	P	20**	11 - 14	FX	1.1/.042	765	SS ^{AA}
JGA-510-765FF	Full Size	DeVilbiss	JGA	Conv	Medium - Heavy	P	20**	11 - 14	FF	1.4/.055	765	SS ^{AA}
JGA-510-797FF	Full Size	DeVilbiss	JGA	Conv	Medium - Heavy	P	21**	11 - 14	FF	1.4/.055	777	SS ^{AA}
JGHV-531-46FX	Full Size	DeVilbiss	JGHV	HVLP	Light - Medium	P	22.5*	11	FX	1.1/.042	46MP	SS ^{AA}
JGHV-531-46FF	Full Size	DeVilbiss	JGHV	HVLP	Light - Medium	P	22.5*	11	FF	1.4/.055	46MP	SS ^{AA}
EGA-503-390F	Touch Up	DeVilbiss	EGA	Conv	Light - Medium	S/P	3	3	F	1.0/.039	390	SS ^{AA}
EGHV-531-397E	Touch Up	DeVilbiss	EGHV	HVLP	Light - Medium	S/P	8.8*	6	E	1.8/.070	397	SS ^{AA}
2101-2800-7	Full Size	Binks	2100	Conv	Light	P	9	14	63BSS	1.2/.046	63PB	SS ^{AAA}
2101-2821-3	Full Size	Binks	2100	Conv	Medium	P	11.6	16	63BSS	1.2/.046	21MD-3	SS ^{AAA}
2101-4321-2	Full Size	Binks	2100	Conv	Medium	S	15.2	11	66SS	1.8/.070	21MD-2	SS ^{AA}
6143-0901-5	Touch Up	Binks	115	Conv	Light - Medium	S/P	2.8	7	78SS	1.8/.070	78SD	SS ^{AA}
6143-0901-3	Touch Up	Binks	115	Conv	Light - Medium	S/P	4.2	8	78SS	1.8/.070	78SD	SS ^{AA}

See page 20 for siphon feed cups

Notes: * CFM at 50 psi P Pressure Feed
 ** CFM at 60 psi ^{AA} UHMWPE and Carboly Tips and Needles are available
 S Siphon Feed ^{AAA} VT (Vitreous) set-up is available

Medium & High Pressure *Spray Guns*



Binks Airless 75 & 75M Spray Guns

- Sprays high solids and heated coatings up to 7500 psi
- Two finger trigger reduces operator fatigue
- 75M features larger 3/8" inlet for spraying fire retardants and fibrous coatings

AIRLESS 75	
Max. Fluid Pressure:	7500 psi (517 bar)
Max. Temperature:	175°F (79°C) (Heat Guard Required)
Fluid Path:	Stainless Steel
Fluid Inlet:	1/4" NPS (3/8" NPS for 75M)
Gun Weight:	660g

Binks AA1600 & AA4400 Air-Assisted Airless Spray Guns

- Lightweight gun and ergonomic handle reduce operator fatigue
- AA1600 with UHMW seat is ideal for spraying low to medium viscosity coatings
- AA4400M with Tungsten Carbide seat is best for high viscosity applications
- A wide variety of twist and flat tip sizes are available for different coatings

	AA1600M	AA4400M
Max. Fluid Pressure:	1600 psi / 110 bar	4400 psi / 303 bar
Max. Air Pressure:	100 psi / 6.8 bar	100 psi / 6.8 bar
Fluid Path:	Stainless Steel / UHMW / Tungsten Carbide	Stainless Steel / Tungsten Carbide
Fluid Inlet:	1/4 NPS (m) Thread	1/4 NPS (m) Thread
Air Inlet:	1/4 NPS (m) Thread	1/4 NPS (m) Thread
Gun Weight: Without Tip, Air Cap, Guard	17.28oz / 490g	17.42oz / 494g

TWIST TIP & FLAT TIP ORDERING CHART					
Orifice Size	Fan Pattern Size (in.)	Twist Tip Part No.	All 9-Series Tips- GPM Flow*	Flat Tip Part No. (AA1600 & AA4400)	All 114-Series Tips- GPM Flow*
.007	6	9-307-75	0.050	—	—
.009	6	9-309-75	0.090	—	—
.009	8	9-409-75	0.090	—	—
.009	10	9-509-75	0.090	—	—
.011	6	9-311-75	0.120	—	—
.011	8	9-411-75	0.120	—	—
.011	10	9-511-75	0.120	—	—
.011	12	9-611-75	0.120	—	—
.013	6	9-313-75	0.180	—	—
.013	8	9-413-75	0.180	—	—
.013	10	9-513-75	0.180	—	—
.013	12	9-613-75	0.180	—	—
.013	14	9-713-75	0.180	—	—
.015	6	9-315-75	0.240	114-01506	0.120
.015	8	9-415-75	0.240	114-01508	0.120
.015	10	9-515-75	0.240	114-01510	0.120
.015	12	9-615-75	0.240	114-01512	0.120
.015	14	9-715-75	0.240	114-01514	0.120
.015	16	—	0.240	114-01516	0.120
.015	18	—	—	114-01518	0.120
.017	6	—	—	114-01706	0.160
.017	8	9-417-75	0.310	114-01708	0.160
.017	10	9-517-75	0.310	114-01710	0.160
.017	12	9-617-75	0.310	114-01712	0.160
.017	14	9-717-75	0.310	114-01714	0.160
.017	16	—	—	114-01716	0.160
.017	18	—	—	114-01718	0.160
.019	6	—	—	114-01906	0.190
.019	8	9-419-75	0.380	114-01908	0.190
.019	10	9-519-75	0.380	114-01910	0.190
.019	12	9-619-75	0.380	114-01912	0.190
.019	14	—	—	114-01914	0.190
.019	16	—	—	114-01916	0.190
.019	18	—	—	114-01918	0.190
.021	10	9-521-75	0.470	114-02110	0.240
.021	12	9-621-75	0.470	114-02112	0.240
.021	14	—	—	114-02114	0.240
.021	16	—	0.470	114-02116	0.240
.021	18	—	0.470	114-02118	0.240
.023	10	9-523-75	0.570	—	—
.023	12	9-623-75	0.570	—	—
.024	10	—	—	114-02410	0.310
.024	12	—	—	114-02412	0.310
.024	14	—	—	114-02414	0.310
.024	16	—	—	114-02416	0.310
.024	18	—	—	114-02418	0.310
.025	10	9-525-75	0.670	—	—
.025	12	9-625-75	0.670	—	—
.027	10	—	—	114-02710	0.385
.027	12	9-627-75	0.740	114-02712	0.385
.027	14	—	—	114-02714	0.385
.027	16	—	—	114-02716	0.385
.027	18	—	—	114-02718	0.385
.035	8	9-435-75	1.31	—	—

*Note: All tip flow rates measured @ 500 psi water pressure

Part No.	Fluid Hose Connection	Brand	Model	Technology	Diffuser	Max. Fluid Pressure Rating (psi)	Tips Used	Air Cap	CFM @ psi	Max. Pattern Size (in.)
0811-7500-1	SS Fluid Tube	Binks	Airless 75	Airless	Three Hole	7500	Twist Tip	—	—	See Tip Chart*
0811-7500-2	Direct Connect	Binks	Airless 75	Airless	Three Hole	7500	Twist Tip	—	—	See Tip Chart*
0811-7500-3	Direct Connect	Binks	Airless 75	Airless	Single Hole	7500	Twist Tip	—	—	See Tip Chart*
0811-7500-4	Direct Connect	Binks	Airless 75M	Airless - For Heavy / Filled Material	Single Hole	7500	Twist Tip	—	—	See Tip Chart*
0909-1600-HF0000	SS Fluid Tube	Binks	AA-1600M	Air-Assist Airless	Single Hole	1600	Flat Tip	HVLP	8.3@14	See Tip Chart*
0909-1600-HT0000	SS Fluid Tube	Binks	AA-1600M	Air-Assist Airless	Single Hole	1600	Twist Tip	HVLP	8.3@14	See Tip Chart*
0909-4400-HF0000	SS Fluid Tube	Binks	AA-4400M	Air-Assist Airless	Single Hole	4400	Flat Tip	HVLP	8.3@14	See Tip Chart*
0909-4400-HT0000	SS Fluid Tube	Binks	AA-4400M	Air-Assist Airless	Single Hole	4400	Twist Tip	HVLP	8.3@14	See Tip Chart*
0909-4400-LF0000	SS Fluid Tube	Binks	AA-4400M	Air-Assist Airless	Single Hole	4400	Flat Tip	LVMP	13@30	See Tip Chart*
0909-4400-LT0000	SS Fluid Tube	Binks	AA-4400M	Air-Assist Airless	Single Hole	4400	Twist Tip	LVMP	13@30	See Tip Chart*

Note: * See Tip Chart above. The above part numbers do NOT include tips. Order tips separately.

Ransburg Robot Mounted *Electrostatic Applicators*

Ransburg is the comprehensive source for automation and robotic finishing solutions. Ransburg offers a full line of automated system products that provide the most efficient, flexible and cost effective system solutions.

RMA 500 Series Rotary Atomizers

The Ransburg RMA-500 series of applicators deliver extremely high transfer efficiency with speeds of up to 100,000 rpm. These robot mounted atomizers are capable of spraying a broad range solvent borne and waterborne coatings electrostatically or non-electrostatically.

RMA 500 Series Rotary Atomizer Provide:

- Extremely high transfer efficiency – less costly waste and less paint required
- Fitting-less tubing bundles – for ease of maintenance and flexibility in the robot wrist
- Internal solvent and air valves – allow for fast solvent/air chop to quickly and efficiently clean the interior and exterior of the bell cup
- Durability – 3 year or 15,000 hour warranty

RMA-550 FM Approved Direct Charge Rotary Atomizer

The only FM approved robotic rotary atomizer available on the market today.

RMA-560 Direct Charge Robot Mounted Rotary Atomizer

This RMA is capable of spraying solvent borne coatings electrostatically or non-electrostatically. It has a true dual purge capability to spray one color while cleaning the other paint line offering increased productivity. It has the latest in high speed spindle design technology, bell cup and shape air design.

RMA-570 Indirect Charge Applicator

The RMA-570 is designed to spray waterborne coatings electrostatically or non-electrostatically. It is capable of fast color changes with the center feed fluid delivery.



MMA-570 Machine Mount Atomizer

The MMA-570 is an automatic machine mountable rotary atomizer ideal for applying solvent or waterborne coatings, electrostatically or non-electrostatically. It is available in direct or indirect charge technology.



RMA-580 Hybrid Direct Charge Water or Solvent Borne Applicator

The RMA-580 is designed to apply both waterborne and solvent borne coatings electrostatically using a direct charge method. An internal cascade applies high voltage to the coating material as it exits the applicator. It is able to spray waterborne materials with direct charge in conjunction with an isolation system like the Ransburg Voltage Block.



RMA-590 Hybrid Direct Charge Solvent or Indirect Charge Waterborne Applicator

This proven hybrid applies waterborne coatings using indirect charge and solvent borne materials using direct charge making the RMA-590 one of the most versatile applicators in the market today. It has an industry first, dual cascade technology. The flexibility of the using the same applicator for both can save valuable time and labor while providing increased uptime.



Ransburg Atomizers & Process Controls *for Electrostatic*

Powder Robotic Applicator

The RPA-2 is one of the most technically advanced powder applicators on the market today. It provides bell-like performance features including uniform film build and high transfer efficiency. The RPA-2 produces one of the largest spray patterns available and twice the coating capacity – coating more square feet per minute – than any other powder gun or bell.

RPA-2 Provides:

- Typical film builds of up to 3 mil
- Uniform consistency and superior atomization
- An excellent pattern for flat surfaces or “cut ins”
- Quick replacement of applicator for reduced downtime
- Minimal installation time compared to other bell type applicators
- No moving parts

Evolver 560 Robotic Atomizer

The Evolver 560 is a compact automatic electrostatic spray gun that is simple, reliable and designed to reduce coating usage while providing maximum uptime.



This electrostatic gun utilizes single and dual purge valve manifolds with all valves grounded within the manifold. This advanced design allows for use with conductive solvent borne materials.

This applicator fits various types of robots and can accommodate four different gun configurations. The applicators quick color change minimizes downtime to keep your system up and running.

Aerobell 168 Rotary Atomizer

The Aerobell 168 is a compact rotary atomizer with a robust, proven air bearing design. It offers a wide variety of bell cups and shape air rings that provide optimum performance and flexibility when coating anything from wheel rims to large panels.



Ransburg bell cup technology provides superior coating atomization to offer the best finishes available.



MicroPak 2e

The Ransburg MicroPak 2e is used to provide high voltage for electrostatic equipment in conjunction with a Ransburg cascade. The system uses a combination of proven high voltage generation technology, including microprocessor-based control with diagnostic and communication functions. It can be used with an Aerobell, Evolver or RMA applicators.



9060 Power Series

The Ransburg 9060 power platform, based on proven Ransburg voltage generation technology, is a series of high and low voltage power supplies for electrostatic applicators. The 9060 HV series is for use with the automatic applicators.



Air Heater

In automated finishing applications, the expansion of pressurized air results in condensation. The Ransburg Air Heater is designed to reduce or eliminate condensation that may form in or on bells, air turbines, or fluidized powder beds or other pressurized applicators under certain operating conditions. It is an effective, low cost solution to reduce condensation problems in high humidity climates.



Automatic Spray Guns



AGMD Pro



Trophy HVLP, LVMP
and Conventional



Compact I



Compact X
with manifold



Model 21 Conventional

DeVilbiss AGMD Pro

- DeVilbiss LVMP Compliant Atomization Technology – 3 caps
- New radial clamping device with quick release cam operation
- Suitable for waterborne and solvent base coatings
- Can be configured for standard machine mount or robot mount

DeVilbiss Compact Automatic I & X

- Conventional, Trans-Tech and HVLP
- Compact X can be removed quickly from its mounting block by an easy thumb release
- Stainless steel fluid passages for waterborne or solvent materials
- Independent fan, atomizing and triggering air – key for robot and machine applications

Binks Trophy Automatic Spray Gun

- Tuff tip hardened stainless steel nozzles
- Tungsten carbide, plastic tipped needles
- Large air and fluid passages for maximum efficiency and finish quality

Binks Model 21 Automatic Spray Gun

- Performs under the most extreme conditions
- Capable of spraying a wide range of materials/viscosities
- Perfect for rotary, reciprocating and spindle machines

Part No.	Brand	Model	Technology	Material Compatibility	Fluid Nozzle	Fluid Nozzle (mm / in)	Air Cap	Needle Tip
AGMDPRO-0000-10P	DeVilbiss	AGMDPRO	Trans Tech	Light-Medium	10	1.0/.039	w/o cap	Plastic
AGMDPRO-0000-12P	DeVilbiss	AGMDPRO	Trans Tech	Light-Medium	12	1.2/.047	w/o cap	Plastic
CMAI-10	DeVilbiss	Compact I	HVLP	Light-Medium	10	1.0/.039	HVLP, TT*, Conv	SS
CMAI-14	DeVilbiss	Compact I	HVLP	Light-Medium	14	1.4/.055	HVLP, TT*, Conv	SS
CMAI-14P	DeVilbiss	Compact I	Trans Tech	Light-Medium	14	1.4/.055	HVLP, TT*, Conv	Plastic
CMAI-G10-M-510	DeVilbiss	Compact X	Trans Tech	Light-Medium	10	1.0/.039	510	SS
CMAI-B14-M-507	DeVilbiss	Compact X	HVLP	Light-Medium	14	1.4/.055	507	SS
CMAI-G14-513	DeVilbiss	Compact X	Trans Tech	Light-Medium	14	1.4/.055	513	SS
3465-12HV-32S0	Binks	Trophy	HVLP	Light-Medium	12	1.2/.047	32H	SS
3465-12HV-39S0	Binks	Trophy	HVLP	Light-Medium	12	1.2/.047	39H	SS
3465-14HV-39S0	Binks	Trophy	HVLP	Light-Medium	14	1.4/.055	39H	SS
3465-10LV-25S0	Binks	Trophy	LVMP	Light-Medium	10	1.0/.039	25L	SS
3465-12LV-25S0	Binks	Trophy	LVMP	Light-Medium	12	1.2/.047	25L	SS
6220-2800-1	Binks	Model 21	Conventional	Light-Medium	12	1.2/.047	63PB	SS
6220-2821-3	Binks	Model 21	Conventional	Medium-Heavy	12	1.2/.047	21MD-1	SS

Other air cap and tip combinations are available for these guns. Order air cap separately for the CMAI and AGMD Pro automatic guns.

* TT stands for Trans-Tech

Maple Pumps

Binks Maple Pumps — Low & Medium Pressure

The Maple pump series are horizontal piston pumps used for circulation and spray gun feed applications. The pumps combine an energy efficient air motor with a low shear fluid section technology. The patented air valve design includes a magnetic detent that reduces stall conditions.

Recommended Materials: Waterborne, high solids, high abrasives, UV cured, solvent borne and catalyst

Typical Applications: Circulation systems and spray gun applications

Binks Maple are among the Finishing Industry's best pump solution for circulation systems and amount the Top Choice for Automotive OEM customers.

- Reduction in Energy costs – Efficient design reduces air consumption
- Reliable Operation – Backup seal ensures continued operation of pump until next shift
- Patented Air Valve Technology – Allows pump to changeover quickly to significantly reduce pulsation
- Simple to Maintain – No “upper seal” to keep lubricated or adjusted
- 5 year limited product warranty



Maple 15



Maple 60



Ordering Information

	Maple 15	Maple 30	Maple 60	Maple 20 AFP*	Maple 7/15	Maple 8/25
Part No.	104009-N	104010-N	104020	104016	104041-N	104042-N
Weight	46 lbs (21 kg)	66 lbs (30 kg)	145 lbs (66 kg)	77 lbs (35 kg)	57 lbs (26 kg)	88 lbs (40 kg)
Ratio	3:1	3:1	3:1	4.2:1	15:1	25:1
Flow @ 60 Cycles/Min	6 gal (23 liters)	12 gal (45 liters)	24 gal (91 liters)	6.8 gal (26 liters)	2.6 gal (10 liters)	3.2 gal (12 liters)
Displacement / Cycle	375 cc / 0.1 gal	750 cc / 0.2 gal	1,500 cc / 0.4 gal	475 cc / 0.125 gal	166 cc / 0.044 gal	200 cc / .053 gal
Inlet Fluid Connection	1" Sanitary	1 1/2" Sanitary	1 1/2" Sanitary	1" Sanitary	1" Sanitary	1" Sanitary
Outlet Fluid Connection	1" Sanitary	1 1/2" Sanitary	1 1/2" Sanitary	3/4" Sanitary	1/2" NPT Female	1/2" NPT Female
Air Connection	3/8 NPS (m) / BSP (m)	3/8 NPS (m) / BSP (m)	3/8 NPS (m) / BSP (m)	3/8 NPS (m) / BSP (m)	3/8 NPS (m) / BSP (m)	3/8 NPS (m) / BSP (m)
Wetted Materials						
Max Fluid Pressure	300 psi (21 bar)	300 psi (21 bar)	300 psi (21 bar)	420 psi (29 bar)	1,575 psi (109 bar)	2,625 psi (181 bar)
Air Consumption @ 45 psi	0.17 scfm / cycle	0.33 scfm / cycle	0.75 scfm / cycle	0.33 scfm / cycle	0.33 scfm / cycle	0.7 scfm / cycle

*For use with piggyback systems with push and solvent air chop.

See A41-114 for accessories and connection kits for the Maple pumps



Smart & Low Pressure Pumps

Binks Smart Pumps — Electric Circulation Pumps

The Binks series Smart Pumps use standard electric motors to drive the fluid section for pumping paints, solvents and other suitable materials. Smart pumps are available in different models with flow rates from 1 gpm -16 gpm and pressure up to 290 psi.

Smart pumps achieve a reciprocating drive by using a cam and cam followers combined with a sliding carriage unit. Equal thrust on each stroke together with the special cam profile reduces fluid pressure fluctuations to an absolute minimum.

The Smart Pump has the available Smart Card that provides higher energy savings and lower operational cost by running in an open or closed loop mode which delivers paint to the use point at the correct pressure and volume only when needed. Operational costs are much lower than compressed air driven models.

The control card contains software to control the paint flow rate and system pressure with set parameters. The paint system can be used in the most efficient pressures and flow rates at all times to reduce energy consumption and pump component wear.

- Pulsation Free Operation – Constant velocity Cam provides equal pressure on both pistons
- Smart Pump Delivers Constant Flow Control – Motor Hz is directly related to material flow rate
- Reduced Energy Costs – Smart Circulation system significantly reduces energy usage and paint shear
- No Exterior Leaking Seal – Backup seal ensures continued operation of pump until the next shift

Recommended Materials: Waterborne, solvent borne, high solids, and moisture sensitive materials

Typical Applications: Circulation systems

	E2-15	E2-30	E2-40	E2-60	E4-60
Part No.	104018-21	107074-21	107094-21	104086-311	107073
Weight	172 lbs (78 kg)	550 lbs (250 kg)	550 lbs (250 kg)	650 lbs (295 kg)	793 lbs (360 kg)
No. of Pistons	2	2	2	2	4
Max Flow 40 Cycles	4 gpm (15 L)	8 gpm (30 L)	10.6 gpm (40 L)	16 gpm (60 L)	16 gpm (60 L)
Flow/Cycle	0.13 gal (0.5 L)	0.2 gal (0.75 L)	0.26 gal (1.0 L)	0.4 gal (1.5 L)	0.4 gal (1.5 L)
Max. Fluid Pressure	290 psi	290 psi	260 psi	290 psi	290 psi
Electric Motor	1 HP	2 HP	2 HP	5 HP	5 HP
Fluid Connection	1" Sanitary	1.5" Sanitary	1.5" Sanitary	1.5" Sanitary	2" Sanitary

See A41-114 for Smart Pump Accessories



Binks Pogo Plus Low Pressure Pumps

- Designed for supplying coatings and materials to a spray gun or for fluid transfer applications
- Two-ball, double acting piston stick pumps
- Stainless steel models with PTFE or UHMW packings
- Good with water or solvent borne paints, adhesives and solvents



SPRAY FINISHING OUTFITS		
Outfit	98-3063	98-3062
Pump	PX1304-5U	PX1304-5U
Gun	Trophy Conventional 2465-18CN-11S0	2100 66SS x 66SD-3
Air Control	41-28272	41-28272
Air Hose 25 ft.	71-4803	71-4803
Fluid Hose 25 ft.	71-3303	71-3303
Drum Bung Adaptor	41-28331	41-28331

For additional information see A41-114

POGO PLUS PUMP PERFORMANCE				
	PX1304-5U	PX1304-5P	PX1304-8U	PX1304-8P
Pressure Ratio	4:1	4:1	4:1	4:1
Air Inlet Pressure (bar)	0-72.5 psi (5)	0-72.5 psi (5)	0-116 psi (8)	0-116 psi (8)
Fluid Pressure (bar)	0-290 psi (20)	0-290 psi (20)	0-500 psi (34)	0-500 psi (34)
Cycles Per Gallon	47	47	47	47
Displacement Per Cycle	2.7 (81 cc)	2.7 (81 cc)	2.7 (81 cc)	2.7 (81 cc)
Flow @ 60 Cycles/Min.	1.3 gal. (4.91l/m)	1.3 gal. (4.91l/m)	1.3 gal. (4.91l/m)	1.3 gal. (4.91l/m)
Packing Material	UHMW	PTFE	UHMW	PTFE

Low Pressure *Pumps*

Binks DX70 1:1 Diaphragm Pump

- Designed for supply of coatings and materials to a spray gun or for fluid transfer applications
- Includes built-in fluid regulator for virtually pulse free fluid flow
- Available in wall mount, pail mount, cart mount and tripod
- 5 year limited product warranty



98-3224 pail mount with agitator spray package

DX70 READY ASSEMBLED SPRAY OUTFITS INCLUDE SPRAY GUN

Outfit No.	Pump Part No.	Mount	Trophy Gun Part No.
98-3221	DX70R3-PF	Pail	2465-HV1
98-3224	DX70R3-PFA	Pail w/ agitator	2465-HV1
98-3226	DX70R3-CF	Cart	2465-HV1
98-3227	DX70R3-TF	Tripod	2465-HV1
98-3228	DX70R3-WF	Wall	2465-HV1

Outfits include Trophy HVLP spray gun with 1.0 mm, 1.4 mm, and 1.8 mm set ups, 25' Ergoflex hose, and 25' fluid hose

PUMP SPECIFICATIONS		DX70 Pump Outfit Contents & Part No.	DX70R3-PF	DX70R3-PFA	DX70R3-CF	DX70R3-CFG	DX70R3-WF	DX70R3-TF	DX70R3-TFG
DX70 Pump Specification (Bare Pump)	Description	DX-70 Bare Pump	■	■	■	■	■	■	■
Pump Ratio	1:1	Fluid Regulator	■	■	■	■	■	■	■
Max. Air Pressure	100 psi/7 bar	Filter Assembly	■	■	■	■	■	■	■
Nominal Flow Volume/Cycle	0.018 gal (0.07 L)	Air Controls 3 Regulators	■	■	■	■	■	■	■
Fluid Output@60 Cycles/min.	1.1 gal/min (4.2 l/min)	Siphon Hose	■	■	■	■	■	■	■
Max. Recommended Continuous Cycle Rate	10 cycles/min.	Agitator		■					
Max. Recommended Intermittent Cycle Rate	30 cycles/min.	Gravity Feed				■			■
		Pail Mount	■	■					
		Tripod Mount						■	■
		Cart Mount			■	■			
		Wall Mount					■		

For additional information see A41-114

Binks Gemini II Double Diaphragm Pumps

Binks Gemini II diaphragm pumps are the premier pumps for spraying, transferring, or circulating a variety of coatings. Gemini II are rugged and designed to provide longer pump life.

- Longer equipment life and lower maintenance costs
- Short stroke pump specifically designed for spraying applications
- 5 year limited product warranty

Outfit example – 98-3202 includes pail mount pump, with dual air control, by-pass filter, pulse assembly, agitator with 25' of air and fluid hose along with a Trophy LVMP Spray gun with 1.4mm tip



1:1 Ratio 1/2" Acetal, Pail Mounted, Dual Air Control, Filter, Agitator, Siphon Hose
PART NO.: GEM2-P2D1D20



1:1 Ratio 1/2" Acetal, Drum Mounted, Dual Air Control, Agitator, Siphon Hose
PART NO.: GEM2-D2D0D10



1:1 Ratio 1/2" Acetal, Wall Mounted, Dual Air Control, Siphon Hose Assembly
PART NO.: GEM2-W2D0040

Additional information for Gemini II Series Pumps and outfits available in catalog A41-108

Air-Assisted Airless Medium Pressure *Pumps*

BINKS. **MX** SERIES **PISTON PUMPS**

- 12:1 and 32:1 ratio packages
- .4 GPM fluid delivery
- Ideal for thin to medium viscosity coatings
- Designed for single gun applications
- Cart, tripod or wall mount options
- Complete packages include gun, hose, air controls, filter and siphon hose



MX4 Outfits (Single Gun)

Model	FEATURES													
	GPM at 60 cycles/min	Ratio	UHMWPE	PTFE/UHMWPE	AA1600M	114-01310	AA1600M	114-01310	AA4400M	114-01310	AA4400M	114-01310	Air Assist	Cart Mount
MX412UC-EDC1S25	0.4	12:1	■	■	■	■	■	■	■	■	■	■	■	■
MX412UC-FDC1S25	0.4	12:1	■	■	■	■	■	■	■	■	■	■	■	■
MX412UC-EDT1S25	0.4	12:1	■	■	■	■	■	■	■	■	■	■	■	■
MX412UC-FDT1S25	0.4	12:1	■	■	■	■	■	■	■	■	■	■	■	■
MX412UC-EDW1S25	0.4	12:1	■	■	■	■	■	■	■	■	■	■	■	■
MX412UC-FDW1S25	0.4	12:1	■	■	■	■	■	■	■	■	■	■	■	■
MX432PU-GDC1S25	0.4	32:1	■	■	■	■	■	■	■	■	■	■	■	■
MX432PU-HDC1S25	0.4	32:1	■	■	■	■	■	■	■	■	■	■	■	■
MX432PU-GDT1S25	0.4	32:1	■	■	■	■	■	■	■	■	■	■	■	■
MX432PU-HDT1S25	0.4	32:1	■	■	■	■	■	■	■	■	■	■	■	■
MX432PU-GDW1S25	0.4	32:1	■	■	■	■	■	■	■	■	■	■	■	■
MX432PU-HDW1S25	0.4	32:1	■	■	■	■	■	■	■	■	■	■	■	■



- 12:1 and 31:1 ratio packages
- 1.2 GPM fluid delivery
- Ideal for thin to medium viscosity coatings
- Supports 1-2 guns in air assisted airless applications
- Cart or wall mount options
- Complete packages include gun, hose, air controls, filter and siphon hose



MX12 Outfits (1-2 Guns)

Model	FEATURES													
	GPM at 60 cycles/min	Ratio	UHMWPE	PTFE/UHMWPE	AA1600M	114-01310	AA1600M	114-01310	AA4400M	114-01310	AA4400M	114-01310	Air Assist	Cart Mount
MX1212UC-EDC1S25	1.2	12:1	■	■	■	■	■	■	■	■	■	■	■	■
MX1212UC-FDC1S25	1.2	12:1	■	■	■	■	■	■	■	■	■	■	■	■
MX1212UC-EDW1S25	1.2	12:1	■	■	■	■	■	■	■	■	■	■	■	■
MX1212UC-FDW1S25	1.2	12:1	■	■	■	■	■	■	■	■	■	■	■	■
MX1231PU-GDC1S25	1.2	31:1	■	■	■	■	■	■	■	■	■	■	■	■
MX1231PU-HDC1S25	1.2	31:1	■	■	■	■	■	■	■	■	■	■	■	■
MX1231PU-GDW1S25	1.2	31:1	■	■	■	■	■	■	■	■	■	■	■	■
MX1231PU-HDW1S25	1.2	31:1	■	■	■	■	■	■	■	■	■	■	■	■



Airless & Air-Assisted Airless High Pressure Pumps

Binks MX Series Heavy Duty Airless & Air Assisted Airless Spray Outfits

Binks MX Pumps are a completely new design in air operated pump technology using a patented magnetic detent to provide fast changeover of the piston stroke with virtually no pulsation. The result is more speed with a more consistent finish.

The MX pumps are available in ratios of 36:1, 42:1, 60:1 and 70:1 with fluid deliveries of 3.0 or 3.5 GPM.

Typical Applications:

Corrosion Protection For –

- Steel fabrications & structures
- Marine & ship building
- Pipe
- Off road vehicles
- Storage tanks
- Trailer & railcar manufacturers



Mounting Setups:

- Bare Pump (no mount provided)
- Cart Mount (shown at left)
- Wall Mount

1. Air controls included for pump and/or air assist spray gun applications
2. Air motor silencer for quiet operation
3. "No-Ice" air motor design keeps the pump from icing up
4. Patented anti-stall magnetic detent technology with quick exhaust valves feature low to no ice operation and uninterrupted production
5. Self adjusting packings increase life with even wear
6. Flat free tires require no maintenance

MX Series Ordering Information

MX3560 60:1 pump carbon steel lower fluid section with PTFE/UHMW packings sold with a 100 mesh filter, 5 gal. siphon kit, Airless 7500 gun w/ fluid tube no tip, 50' airless hose with 5' whip hose.

*Specify tip separately when ordering

ORDERING SYSTEM FOR AIRLESS OUTFITS

	A	B				D	E	F	G	H	
MX	35	60	PU-	C	A	C	1	S	3	2	
A	OUTPUT					E	FILTER				
30	=	3.0 GPM				1	=	100 Mesh			
35	=	3.5 GPM				3	=	30 Mesh			
B	RATIO					5	=	50 Mesh			
36	=	36:1				7	=	70 Mesh			
42	=	42:1				F	SIPHON				
60	=	60:1				0	=	None			
70	=	70:1				S	=	5 Gallon			
C	MATERIAL					T	=	55 Gallon			
C	=	Carbon Steel				G	GUN				
S	=	Stainless Steel				0	=	No Gun			
D	MOUNTING					3	=	Airless 75 0811-7500-3			
C	=	Cart				H	HOSE				
W	=	Wall				0	=	None			
						2	=	25 Feet			
						5	=	50 Feet			

AIR ASSISTED AIRLESS OUTFITS		
95-3230 Single Gun Outfit	Outfit Components	98-3231 2 Gun Outfit
1	MX3536PU-C4C5500 36:1 Ratio, 3.5 GPM Pump, Carbon Steel Fluid Section, Cart Mount, with 50 Mesh Fluid Filter and 5 Gal. Siphon Tube	1
1	28' Air Tubing for Atomizing Air	2
1	25' High Pressure Fluid Hose (1/4" I.D. / 4,000 psi)	2
1	3' High Pressure Whip Hose (1/8" I.D. / 5,000 psi)	2
1	Air Controls for 1 or 2 Guns	2
1	0909-4400-HT0000 AA4400M Air Assisted Airless Spray Gun with HVLP Air Cap and Twist Tip Guard (Tip Not Included - Order Separately)	2

Note: Twist tip not included - order separately

7. Heavy duty cart with lower "grab" handles for easy lifting
8. Carbon or stainless steel housing with ceramic coated step rod design reduces friction in the pump rod movement and is proven tough to increase packing life
9. Large 1 1/2" "knock off" fluid inlet for faster pump assembly and disassembly in the field

Accessories

Binks 55 Gallon Drum Cover Elevator

Single post elevator for lifting 55 gallon cover-mounted pump and agitator units



PART NO.: 41-9000

Binks Low Shear Back Pressure Regulator 3/4 inch or 1 1/2 inch

The back pressure regulator responds to the changes in system fluid pressure (due to variable paint usage) by dynamically adjusting to maintain the set pressure, thus maintaining the required system back pressure. It is excellent with metallics.



See www.Binks.com Accessories for Selection Chart

Binks Inline Piggable Modular Color Changer

This color changer assembly was designed for use with a paint circulating system that can also operate as a piggable fluid delivery system.



PART NO.: A12800-XX

Binks Surge Eliminator Standard Flushable

The Surge Eliminator compensates for the momentary reduction in fluid pressure and flow at the point of pump stroke changeover allowing for a constant fluid pressure in the circulation system. An active flushable surge eliminator is also available.



See www.Binks.com Accessories for Selection Chart

Binks Pressure Relief Valve

An electrical detection system is usually installed to detect and stop the pump when a potentially damaging high pressure is reached. The mechanical valve can be easily installed on the pump outlet manifold.



PART NO.: PRV22-X-XX

Binks Fluid Heaters

Working capacity to 5000 psi and with adjustable thermostatic control from 60° to 250°F.



PART NO.: 830000

Part No.	Description
830000	120 vac (16.6 amps)
830001	240 vac (8.33 amps)

Binks Quick-Mixers for Container Sizes of 5 to 55 gallon

- Designed for standard and extra heavy industrial uses
- Unsurpassed for paints, resins, chemicals, and slurries
- High performance, explosion-proof direct drive air motor 1/2 hp
- Rugged stainless steel shaft and impeller
- High shear mixer blades thoroughly mix 5 gal of paint in less than 60 seconds



Model No. Complete:	149-873 (1/2 HP)	149-874 (1/2 HP)
Model No. Stainless Steel Mixer Only:	149-365 (shown)	149-693
Container Size:	5 and 10 gallons	55 gallons
Shaft Length x Diameter:	21 in. x 1/2 in.	40 in. x 1/2 in.
Impeller Diameter:	5 in.	5 in.
Shaft Length:	21 in.	40 in.
Shipping Weight:	9 lbs.	10 lbs.
Ref. Part Sheet:	77-2826	77-2826

Binks Agitators

5 gal. pail-mounted direct drive agitator fitted with zinc plated chromate cover.



PART NO.: 31-425

See Catalog A31-7R-1 for the full line of Binks Agitators

Pressure Feed Tanks

Binks Stainless Steel Pressure Tanks

Binks 183S- ASME Code Tanks give you application flexibility with our best chemical resistance. Suitable for waterborne coatings.

ASME CODE STAINLESS STEEL TANKS									
Single Regulated	Double Regulated	Single Regulated with Extra Sensitive Regulator	Double Regulated with Extra Sensitive Regulator	Direct Drive Agitator	20:1 Gear Reduced Agitator	2 gal. Tank Part No.	5 gal. Tank Part No.	10 gal. Tank Part No.	15 gal. Tank Part No.
■						183S-200	183S-500	183S-1000	183S-1500
■				■		183S-210	183S-510	183S-1010	183S-1510
■						183S-211	—	—	—
					■	183S-213	183S-513	183S-1013	183S-1513
	■					183S-220	183S-520	183S-1020	183S-1520
	■			■		183S-221	—	—	—
	■				■	183S-223	183S-523	183S-1023	183S-1523
		■				183S-230	183S-530	183S-1030	183S-1530
		■		■		183S-231	—	—	—
		■			■	183S-233	183S-533	183S-1033	183S-1533
			■	■		183S-240	183S-540	183S-1040	183S-1540
			■	■		183S-241	—	—	—
			■		■	183S-243	183S-543	183S-1043	183S-1543



All 183S Tanks Include Fill Port



5 gal.
PART NO.: 183S-510

Binks 30 & 60 Gallon Tanks

Binks ASME code 30 and 60 gallon tanks are ideal for larger jobs such as line striping or supporting multiple guns. Choose galvanized units for most applications. Choose stainless steel fitted galvanized tanks for waterborne applications.

ASME CODE 30 & 60 GALLON TANKS					
Single Regulated	20:1 Gear Reduced Agitator	30 Gallon Tank in Galvanized Steel	60 Gallon Tank in Galvanized Steel	30 Gallon Shell in Galvanized Steel (for a Stainless Steel Fitted Tank)	60 Gallon Shell in Galvanized Steel (for a Stainless Steel Fitted Tank)
■		83-5801	83-5701	83-5873 Plus 30 Gallon Liner (See Below)	83-5773 Plus 60 Gallon Liner (See Below)
■	■	83-5807	83-5707	83-5879 Plus 30 Gallon Liner (See Below)	83-5779 Plus 60 Gallon Liner (See Below)

30 & 60 GALLON TANK LINERS			
Top Outlet	Bottom Outlet (Includes Bottom Outlet Kit)	30 Gallon SS Liner	60 Gallon SS Liner
■		83-1569	83-1581
	■	83-2230	83-2229



Binks Zinc-Plated & Stainless Steel 2.8 gal. Pressure Tanks

Binks ASME code PT tanks are a great choice in a 2 gallon pressure tank when spraying up to 80 psi of fluid pressure.

- Choose 83C tanks for solvent borne coatings
- Choose 83Z tanks for waterborne coatings

Air Regulation	Fluid Agitation	Zinc-Plated Throughout, Including Lid, Wetted Parts & Tank Shell	Zinc-Plated Tank Shell, Stainless Steel Lid & Wetted Parts
Single Reg	No Agitation	83C-210	83Z-210
Double Reg	No Agitation	83C-220	83Z-220
Single Reg	Std. Agitation (D)	83C-211	83Z-211
Double Reg	Std. Agitation (D)	83C-221	83Z-221
Disposable Liner	—	PT-78-K10 or K60	PT-78-K10 or K60
Head Gasket	—	PT-33-1	PT-33-1
Service Bulletin	—	SBBI-21-044	SBBI-21-043

NOTE: The air regulator(s) and gauge(s) are shipped inside the tank to prevent damage in shipping.
Bottom outlet kits are not available for 83C or 83Z pressure tanks.

(D) = Direct Drive Agitator: Uses direct mount air motor and air adjusting valve.



w/ 2 Regulators
PART NO.: 83C-220



w/ Agitator (2 Regulators)
PART NO.: 83C-221

Pressure Feed Tanks & Solvent Savers

Binks Galvanized Steel 2, 5, 10 & 15 Gallon Pressure Tanks

Binks 183G- ASME Code Tanks give you application flexibility for most solvent borne applications.



All 183G Tanks Include Fill Port

ASME CODE GALVANIZED CARBON STEEL TANKS									
Single Regulated	Double Regulated	Single Regulated with Extra Sensitive Regulator	Double Regulated with Extra Sensitive Regulator	Direct Drive Agitator	20:1 Gear Reduced Agitator	2 gal. Tank Part No.	5 gal. Tank Part No.	10 gal. Tank Part No.	15 gal. Tank Part No.
■						183G-200	183G-500	183G-1000	183G-1500
■						183G-210	183G-510	183G-1010	183G-1510
■				■		183G-211	—	—	—
					■	183G-213	183G-513	183G-1013	183G-1513
						183G-220	183G-520	183G-1020	183G-1520
	■			■		183G-221	—	—	—
	■				■	183G-223	183G-523	183G-1023	183G-1523
	■					183G-230	183G-530	183G-1030	183G-1530
		■		■		183G-231	—	—	—
		■			■	183G-233	183G-533	183G-1033	183G-1533
			■	■		183G-240	183G-540	183G-1040	183G-1540
			■	■		183G-241	—	—	—
			■		■	183G-243	183G-543	183G-1043	183G-1543

2 gal.
PART NO.:
183G-210



5 gal.
PART NO.:
183G-523

Binks Bottom Outlet Kits for 183G- & 183S- ASME Code Tanks

Bottom outlet kits include sturdy steel legs, mounting fasteners, fittings, and outlet pipe.



	Bottom Outlet Kit	Fluid Outlet if Using Bottom Outlet Kit
2 Gallon Tanks	183-3000	3/4" npt (m) or 3/4" nps (m)
5, 10 and 15 Gallon Tanks	183-3001	3/4" npt (m) or 3/4" nps (m)

183-3005: One leg plus fasteners. Order one to replace a damaged leg. Order three to raise a tank without bottom outlet plumbing.

Solvent Saver is designed to flush fluid hoses and guns using much less solvent.

TO ORDER QUICK DISCONNECT (QD) KIT:

- (2) P-HC-4808-1 QD Body for fluid hose
- (3) P-HC-4482 QD Stem for gun, tank, solvent saver

How to Use the Solvent Saver

TO FLUSH FLUID HOSE & GUN:

1. Shut off air pressure to tank - loosen tank lid
2. Loosen air cap on spray gun 2-3 turns
3. Hold rag over air cap, pull trigger, blow atomizing air backward through fluid line into tank
4. Remove QD "B" from tank and connect to QD stem "C" on solvent saver
5. Turn off atomizing air to the spray gun
6. Open ball valve on solvent saver while pulling trigger on spray gun
7. Spray solvent into a grounded waste container until it sprays clear
8. Air/solvent "chop" is cleaning fluid hose and spray gun
9. Connect QD "C" back onto QD Stem "B" on pressure tank
10. If desired, remove QD "A" and attach to QD "C" to flush solvent through pick-up tube of paint tank



DEVILBISS
2 qt. Hose/
Gun Cleaner
Aluminum
& Brass
Construction
PART NO.: HD-503



BINKS
2 gal.
Solvent Saver
Galvanized Steel,
Aluminum &
Brass
Construction
PART NO.: 183GZ-5200

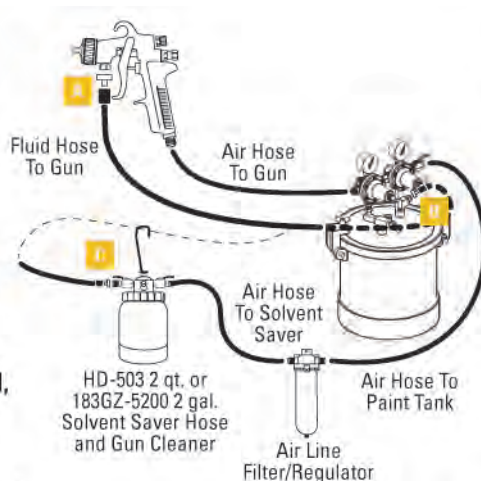

Tank Liners & Cups

Binks Pressure Tank Liners



- Disposable anti-static polyethylene liners
- Seamless, vacuum-formed pail liners have a contoured lip that snaps over a pail's top bead to prevent leakage between the pail liner and the pail wall

Part No.	Size	Tank Series	Qty.	Liner Dia.	Liner Ht.	Liner Wt.	Strell Inside Dia.
Liners for 2 qt. SG-2 Cups							
80-356	2 qt.	80-350/80-351, 80-451, 80-600, 80-601, 80-651	12	6"	6 1/4"	1 oz.	5.9"
Liners for A.S.M.E. Stainless Steel Pressure Tanks							
6-238-60	2 gal.	83-155XX, 183S & 183G Series	60	9"	10 3/4"	3 oz.	9"
PT-78-K10	2.8 gal.	83Z-2XX, 83S-2XX, QMST-52XX*, 183S & 183G Series	10	9 1/4"	9 1/2"	3 oz.	9 1/2"
PT-78-K60	2.8 gal.	83Z-2XX, 83S-2XX, QMST-52XX*, 183S & 183G Series	60	9 1/4"	9 1/2"	3 oz.	9 1/2"
6-277	5 gal.	83-154XX, 183S & 183G Series	15	13 9/16"	15 3/4"	9.8 oz.	14"
6-278	10 gal.	83-153XX, 183S & 183G Series	12	14"	19 1/2"	10 oz.	14"
PTL-408-K20	9.8 gal.	83S-5XX, QMST-55XX*, 183S & 183G Series	20	13 9/16"	15 3/4"	9.8 oz.	14"
PTL-412-K8	11.8 gal.	83S-10XX, QMST-510XX*, 183S & 183G Series	8	13 1/2"	18 5/8"	10 oz.	14"
PTL-415-K10	19.8 gal.	83S-15XX, QMST-515XX*, 183S & 183G Series	10	13 11/16"	27 9/16"	16 oz.	14"
Liners for A.S.M.E. Galvanized (Zinc-Plated) Steel Pressure Tanks							
6-238-60	2 gal.	83-5XX, 183S & 183G Series	60	9"	10 3/4"	3 oz.	9"
PT-78-K10	2.8 gal.	83C-2XX, 83G-2XX, QMGT-52XX*, 183S & 183G Series	10	9 1/4"	9 1/2"	3 oz.	9 1/2"
PT-78-K60	2.8 gal.	83C-2XX, 83G-2XX, QMGT-52XX*, 183S & 183G Series	60	9 1/4"	9 1/2"	3 oz.	9 1/2"
6-239	5 gal.	83-54XX, 183S & 183G Series	24	11 15/16"	15 3/4"	6.3 oz.	12"
6-240	10 gal.	83-53XX, 183S & 183G Series	12	13 5/8"	21"	10.5 oz.	14"
PTL-408-K20	9.8 gal.	83G-5XX, QMST-55XX*, 183S & 183G Series	20	13 9/16"	15 3/4"	9.8 oz.	14"
PTL-412-K8	11.8 gal.	83G-10XX, QMGT-510XX*, 183S & 183G Series	8	13 1/2"	18 5/8"	10 oz.	14"
PTL-415-K10	19.8 gal.	83G-15XX, QMGT-515XX*, 183S & 183G Series	10	13 11/16"	27 9/16"	16 oz.	14"
Liners for PT Series Steel Pressure Tanks							
PT-78-K10	2.8 gal.	PT-Series*	10	9 1/4"	9 1/2"	3 oz.	9 1/2"
PT-78-K60	2.8 gal.	PT-Series*	60	9 1/4"	9 1/2"	3 oz.	9 1/2"
Liner for 5 gal. Pail							
PL-5GAL-K40	5 gal.	Pail	40	11 1/4"	13"	4.5 oz.	11 1/2"

Most common liners in Green *Note: QMGT, QMST & PT Series tanks are no longer available for purchase

Binks Gravity, Suction & Pressure Cups



81-540



54-6106



81-800 (Shown) /
81-810 / 81-820



80-294 (Shown) /
80-511



80-600 / 80-601 /
80-651 (Shown)



80-295

Part No.	Description	Brand	Material Feed	Wetted Parts	Fluid Regulation	Air Agitator	Liner Part No.
SRI-510	4 oz. Gravity Cup	Binks	Gravity	Acetyl (Composite)	No	No	None
81-381	8 oz. Gravity Cup	Binks	Gravity	Aluminum	No	No	None
54-6106	1 qt. Gravity Cup	Binks	Gravity	Aluminum	No	No	OMX-70-K48
81-540	8 oz. Siphon Cup	Binks	Siphon	Aluminum	No	No	None
81-800	1 qt. Drip Free Cup	Binks	Siphon	Aluminum	No	No	None
81-810	1 qt. Drip Free Cup	Binks	Siphon	Aluminum & Non-Stick	No	No	None
81-820	1 qt. Drip Free Cup	Binks	Siphon	Stainless Steel	No	No	None
80-294	1 qt. Pressure Cup	Binks	Pressure	Aluminum	Yes	No	None
80-511	1 qt. Pressure Cup	Binks	Pressure	Stainless Steel	Yes	No	None
80-295	2 qt. Steadi-Grip	Binks	Pressure	Aluminum	Yes	No	None
80-600	2 qt. Steadi-Grip	Binks	Pressure	Aluminum	Yes	No	80-356
80-601	2 qt. Steadi-Grip	Binks	Pressure	Aluminum	Yes	Recip Agitator	80-356
80-651	2 qt. Steadi-Grip	Binks	Pressure	Aluminum	Yes	Rotary Agitator	80-356



DeKups Cups



DeKUPS™
Disposable Cup System

DeVilbiss DeKups™ Disposable Cup System

Increase Productivity & Efficiency

- Can be used with suction or gravity feed spray guns
- Less Cleaning – Easy disposal vs. traditional suction / gravity cups that require significant cleaning time and solvent
- Reduces Steps – Mix and spray with one cup. Multiple filter options reduce the need to strain
- Clean Paint Jobs – Sealed, contamination-free system
- Safety – Less exposure to cleaning solvents and VOC's
- Flexibility – Liner systems allows spraying at any angle including upside down
- Multiple Filter Options – Both barrel and disk strainers are available in different mesh sizes

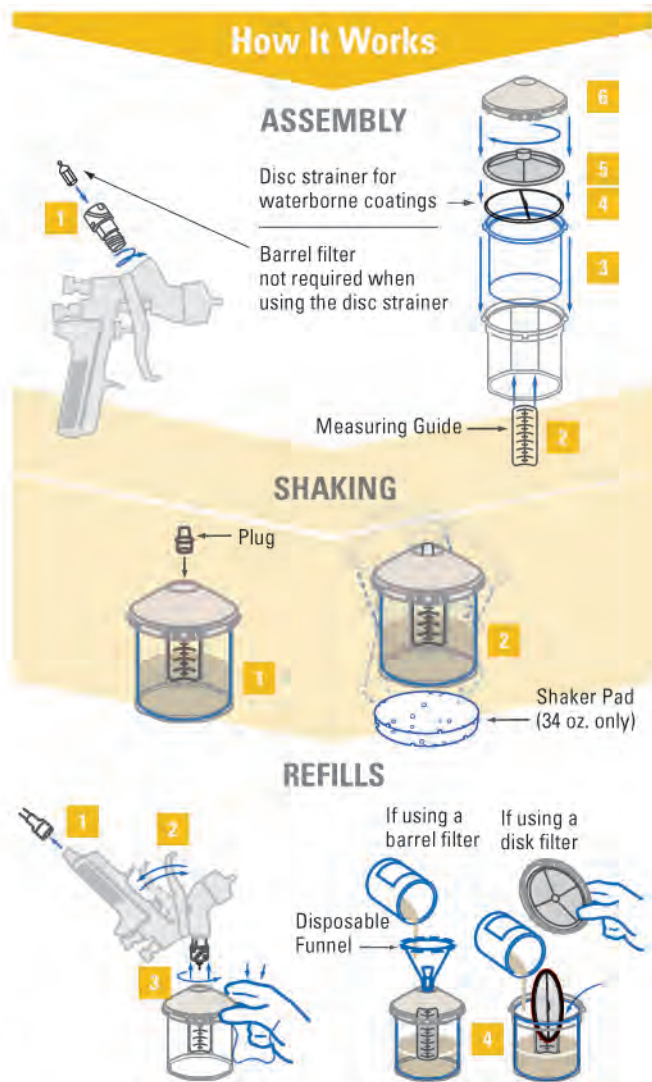

LINER, SLEEVES & LIDS		
Part No.	Description	Qty.
DPC-601	24 oz. Disposable Cup / Lid	32
DPC-602	9 oz. Disposable Cup / Lid	32
DPC-600	34 oz. Disposable Cup / Lid	32
DPC-606	24 oz. Reusable Sleeve / Lid	2
DPC-607	9 oz. Reusable Sleeve / Lid	2
DPC-608	34 oz. Reusable Sleeve / Lid	2
DPC-503-K24	3 oz. Vented Disposable Cup / Lid	24

DEMO KIT		
Part No.	Description	Qty.
DPC-654	24 oz. Demo Trial Kit with Adapter, Reusable Sleeve, Disposable Cups, Plugs, Filters	1

ADAPTERS		
Part No.	Compatible Spray Gun	Qty.
DPC-31	Trophy, Compact, JGA, EXL, FLG, SV100, 95-G, Graco® XT	1
DPC-23	Trophy Touch Up, SRI, Cub, Compact Mini	1
DPC-10	SV50 Full Size, Graco Finex, SATA® NR2000, RP, Sata Jet 90 Series	1
DPC-11	SATA NR95, Iwata® LPH 400 and W400	1
DPC-77	Graco® AirPro	1
DPC-78	Kremlin, Iwata SuperNova, Iwata Air Guns, LPH300 and W300	1
DPC-500	Converter for 3M Adapters	1
DPC-502	SATA Mini Conversion Adapter	1
DPC-504	SATA 3000, 4000 and 5000	1
DPC-79-K1	Siphon: Trophy Touch Up, Cub	1
DPC-69-K1	Siphon Conversion Adapter	1
DPC-26	Accuspray® Adapter	1

ACCESSORIES		
Part No.	Description	Qty.
DPC-60-K10	Measuring Guide 9 oz.	10
DPC-59-K10	Measuring Guide 24 oz.	10
DPC-61-K10	Measuring Guide 34 oz.	10
DPC-65-K24	Disk Filters 125 Micron 9 oz.	24
DPC-42-K24	Disk Filters 125 Micron 24 oz and 34 oz	24
DPC-67-K24	Disk Filters 200 Micron 9 oz.	24
DPC-66-K24	Disk Filters 200 Micron 24 oz. and 34 oz.	24
DPC-27-K10	Barrel Filter - 200 Micron	10
DPC-17-K10	Barrel Filter - 300 Micron	10
DPC-14-K10	Barrel Filter - 600 Micron	10
DPC-22-K24	Disposable Funnels	24
DPC-6-K10	Orange Plugs	10
DPC-44	Cleaning Brush	1
DPC-8	Cleaning Bottle	1

The DeKups® System is covered by U.S. Patent Nos. 6,820,824 and 7,374,111, owned by 3M Innovative Properties Co., additional U.S. Patent Nos. 7,380,680; 7,354,074; 7,353,964; 7,350,418; 7,344,040; 7,263,893; 7,165,732; 7,086,549.

Ransburg RCS 2 Ratio Control System

RCS 2 is the latest generation Ratio Control System which establishes a new standard for precise electronically controlled gear-pump metering.

Fast and reliable, the RCS 2 is the ideal choice for applications where short trigger times, quick response, and/or low flow are required. This can result in substantial savings over other 2K outfits.

The RCS 2 provides absolute on-ratio gear-driven mixing and metering control. RCS 2 features magnetically coupled metering pumps that eliminate shaft seal leaks. The system can be used with solvent borne or waterborne materials. This makes for easy integration into automatic or manual systems using single or multiple applicators.

- Programmable alarm, pot-life timer, and multiple flow rates and ratios
- No mixing chambers to maintain, or external fluid boosters or balancing pumps
- Technology has established record for reliability in high performance finishing
- Trouble free on-ratio performance with no critical seals to worry about leaking or maintaining
- Designed to accommodate color to color changes with no color carryover
- Modular color changer with air/solvent purge
- Can be used with rotary atomizers, bells, disks and electrostatic or non-electrostatic spray guns
- Can be easily integrated into automatic or manual multi-applicator systems
- System can be configured for flow and ratio control for automatic guns or ratio only for manual or hand gun applications



RCS2

Options:

- A programmable 10 color, 12 step color change sequencer
- In-booth intrinsically safe operator interface panel
- The ability to be retrofitted to existing RCS fluid panels
- Remote I/O (ROI) capabilities

SPECIFICATIONS	
Size:	71" H x 25" W x 32" D (1803.4 mm x 635 mm x 812.8 mm)
Weight:	400 lbs. (181.4 kg)
Operating Temperature:	32°F - 130°F (0°C - 54°C)
Operating Humidity:	0% - 95%
Pneumatic Air Consumption:	Less Than 5 cfm
Pneumatic Inlet and Outlet Size:	3/8" ODT
Fluid Capacity:	1.5 cc/min - 1500 cc/min Per Pump
Fluid Inlet Size:	3/8" ODT
Fluid Viscosity Range:	20 - 1000 Centipoise
Fluid Input Pressure:	3 psi - 120 psi
Fluid Outlet Pressure:	200 psi Max.

Ransburg DynaFlow / RansFlow



DynaFlow CC

Versatile Flow Control Platform with Color Change Optimization

- Single location monitoring of multiple systems
- User-friendly back lit LCD touch screen panel display
- Multi-lingual text options
- True closed loop flow control

Able to configure to either 2k meter mix or 1k flow control, the DynaFlow CC system can meet specific application requirements. Processing type control software separates the entire flow process into a series of dedicated functions. Acting on commands from the interface module, the DynaFlow CC monitors, processes and quickly routes vital flow control data.

DynaFlow CC provides closed loop fluid control and can easily accomplish eight single or four multi-component applications. The industry's most adaptable flow metering system has been engineered to provide superior efficiency and production flexibility. The DynaFlow CC offers a graphic display to optimize color change, flush and load sequences.



RansFlow

Precise Ratio Control

- Inlet pressure control
- True programmable 3k operation
- Remote (in-booth) operator panel

The RansFlow is a dynamic fluid metering system which offers closed loop metering and flow control of multi-component materials (2K or 3K). This electronic metering system provides accurate, repeatable and consistent quality finishes. RansFlow delivers critical control and cost savings by reducing reworks and required system maintenance frequency.

Simple and easy to integrate, the RansFlow fits seamlessly into an existing application. The closed loop system is self-correcting and provides an alarm system to prevent paint from hardening in the lines. Flush and fill cycles are programmable to make color changes fast and easy while the microprocessor stores up to 100 different paint recipes.

Ransburg's simple and reliable RansFlow delivers accurate mixing and metering at an affordable price and is designed to work with both manual and automatic systems.

Binks GEMS™ *Global Electronic Mixing Solutions*

GEMS is an advanced 2K mixing system using a simple design that combines an intuitive user touchscreen interface with data collection and analytics. GEMS collects information to improve the consistency of user's finish quality and production.

The System Tracks:

- Production details to better understand material and labor costs
- Color change and flush times
- Alarm history with time stamps

All GEMS systems are configured for up to five colors with one hardener, capabilities for very low and high flow rates and independent monitoring of up to two guns. GEMS can be customized to individual production specifications with additional accessories.



beyond accurate mixing™

GEMS™

Technical Specifications:

- Accurate proportioning from 1:1 to 100:1
- Programmable air/solvent flush
- 7" color industrial touch screen
- On-screen help guide (multiple languages)
- USB and ethernet connections with built in FTP server
- Tracking of up to 100,000 jobs with data exports in .csv and .log formats



GEMS systems can be customized to your specifications with the following accessories:

Description	Notes
Gun Flush Box	Increases user safety, reduces waste/color change times and minimizes labor.
Flow Sensor	Detects air vs. fluid in hardener/catalyst line. Typically integrated with systems utilizing pressure tanks to feed hardener.
In Booth Controls	Allows for in booth color change, flushing, and alarm reset.
Solvent Flow Meter	Measures the volume of solvent used through the system and allows for solvent usage analysis.
Remote Mix Manifold	Designed for one color application to mix materials close to the applicator.
Stack Lights	Two color stack light visually detects alarms and spraying mode.
Atomization Air Cut Off	Automatically shuts off atomization air during flush and color change sequences.
Stand	Attaches to standard wall bracket. Designed to be bolted to floor.

Ransburg Color Change, Waterborne & Ground Monitor *Equipment*

AquaBlock

The Ransburg AquaBlock is a simple and effective way to handle waterborne coatings electrostatically.

The AquaBlock provides a voltage block for the isolation of high voltage paint applicators from grounded, waterborne coating supplies.

By combining advantages of waterborne coating technology with the efficiency of electrostatics, AquaBlock can reduce the environmental impact of a finishing operation as well as reduce operating expenses.



CCV Color Change Valve

This modular color change system incorporates a practical and flexible valving assembly. It is engineered for compatibility with waterborne, high solids and catalyzed coatings. Valving assemblies consist of modular blocks which can easily be expanded to allow for changes to the fluid supply systems.



Color Select System

The Color Select System provides an easy and accurate way of changing up to 15 different coating materials. This patented pneumatically-operated fluid valve assembly is controlled with one or two color select boxes which feature easy to use color select switches.



MCV Color Change Valves

The M series MCV valves handle up to 32 colors and are modular so they meet changing needs in the finishing system. The lightweight, corrosion resistant design makes them very durable. An internal shut-off allows maintenance and repair without shutdown or the need to remove fluid connections.



DR1 Fluid Regulator

The Ransburg DR-1 fluid regulator provides consistent, constant fluid regulation for automatic coating applications. It features stainless steel wetted parts and two selectable fluid flow ranges. Low flow range output delivers precise fluid delivery control. High flow range output accommodates higher fluid deliveries. This combination provides excellent paint film uniformity and minimal color change time.



MCV2 Color Change System

This color change system has a new insert and seal feature that, combined with its modular design, provides quick and easy color change. The MCV2's durable construction is compatible with waterbornes, high solids and catalyzed materials. This valve was developed for the rigorous cycling associated with applicator triggering.



GMS 2 Ground Monitor

GMS 2 monitors the difference between properly grounded parts and those with improper grounding. It enhances an electrostatic system ensuring that operation is at optimum performance. The GMS 2 delivers cost savings by notification of a lack of grounding. Improper grounding can cause overspray, excess paint build up, thin film build, ruined parts or safety hazard.



BGK Automotive OEM Paint Repair

AutoCure™ 3000II Sill Heater

The Sill Heater is engineered specifically to dry door frames, rocker panels and other hard-to-reach areas. This portable unit has a locking mechanism to maintain position. Available in two standard sizes.

AutoCure™ 5000II Portable Heater

The Portable Heater is engineered specifically to dry spot repairs. This portable unit has locking wheels to maintain position. Available in a variety of sizes.

AutoCure™ 6000II Overhead Heater

The Overhead Heater is engineered specifically to be mounted to an XY overhead gantry system. Available in a variety of sizes.

AutoCure™ 7000 Side Mount Heater

The Side Mount Heater is engineered specifically to be mounted to a booth or wall when ceiling clearance is minimal. Available in a variety of sizes.

AutoCure™ 8000 Panel Heater

The Panel Heater is engineered specifically to dry complete panel sections. This portable unit has locking wheels to maintain position. Available in two standard sizes.

Features on All AutoCure™ Models:

- Accurate to $\pm 5^{\circ}\text{F}$
- Automatic control
- Automatic timed heat cycle
- Cycle-time-remaining display
- Automatic shut-off
- Heater remains in place without locking handles
- Single or dual temperature set point capability
- Heating range to 400°F (204°C)

Reciprocators

Available in horizontal or vertical models, with multiple stroke lengths and a variety of standard options.

- Manual or PLC controls
- Adjustable cam spray control
- Moveable base (on vertical model)
- Variable speeds (from 10 – 300 fpm)
- Continuous running or reversing stroke

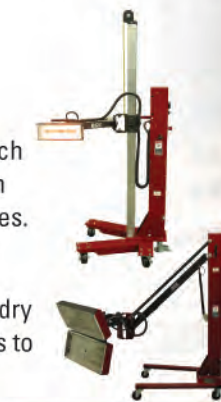

Chain-On-Edge Finishing Systems

BGK provides industry leading technology in oil filter curing systems. These systems utilize flexible, efficient, and modular high intensity infrared curing to meet individual production specifications. These systems can be used for finishing and curing all kinds of other small parts or products.

Typical system components include: chain-on-edge conveyor, coating booth, cool down, infrared oven, rotators, air knife, with automatic load and unload stations.

Four standard Chain-on-Edge systems are available for various part sizes:

- Spindle Master II
- Spindle Pro
- Spindle Boss
- Spindle King

Standard systems can be customized to meet specific customer requirements.



BGK IR & Gas Catalytic *IR Ovens*



IR Ovens

BGK electric infrared curing solutions are designed to cure powder, liquid paints, and other types of finishes and adhesives. These solutions work with all conveyor types and are available in boosters, ovens or combination systems.

Compact modular designs allow for configuration flexibility, while the emitters deliver efficient, clean heat, energy for any application. These curing systems offer higher production rates, lower operating costs and a high quality finish with minimal floor space.

All systems can be custom engineered to fit your production style, layout and finishing requirements.

- Full range infrared - short, medium and long wave
- Flashing, drying and curing
- Wide range of sizes
- For all types of coatings

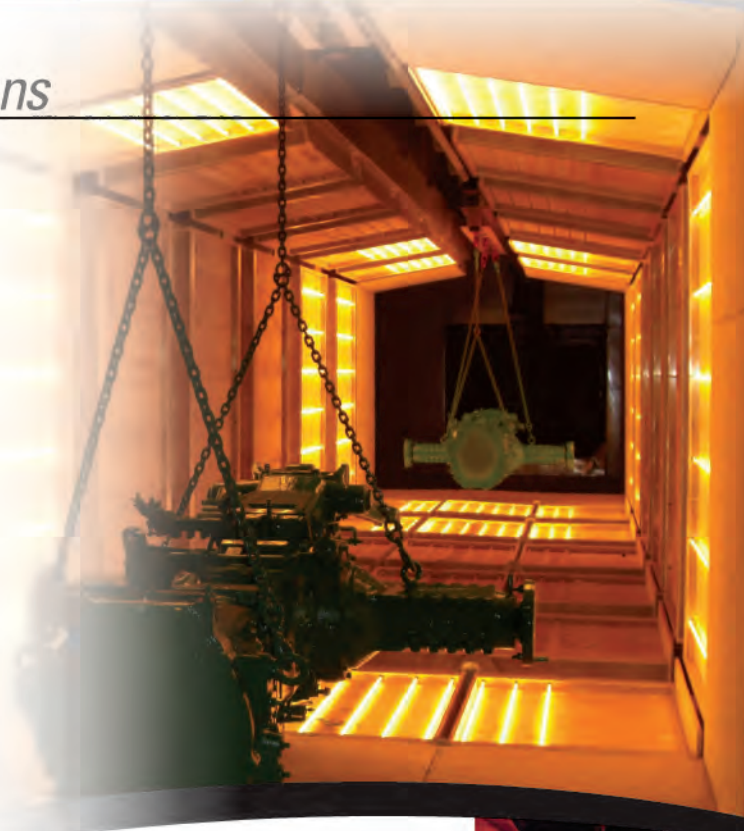

Gas Catalytic Infrared Ovens

Gas catalytic IR ovens provide faster process times than conventional style ovens, resulting in less equipment and floor space. These ovens can improve quality and consistency of finish for powder or liquid applications, drying, curing or heating providing emitter surface temperatures in the range of 700 F to 1000 F.

Catalytic IR Ovens offer both natural gas or propane fired catalytic heaters that emit infrared heat through a safe technology which produces a uniform low intensity heat.

- Smart – IR heats the part, not the surrounding air, taking less time and energy to cure a part
- Versatile – Can handle large range of finishing applications with oddly shaped substrates and complex coatings
- Cost effective – Higher production rates and lower operating costs
- Controllable – Custom engineered packages offer precise control

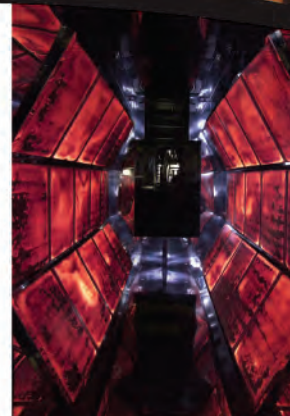

Filters, Regulators & Coalescers

DeVilbiss CleanAir Centrifugal Filter-Regulator Units

Excellent for Eliminating Moisture and Dirt from an Air Supply

DeVilbiss CleanAir centrifugal units supply cleaner, drier air to each spray gun in a system. This cleaner air can also increase the life of pneumatic tools.

- Filters out water and oil aerosols and dirt particulates to 5 microns
- Ideal for most spray applications, air tools and equipment
- Water droplets collected in the bowl are removed by an automatic drain (standard feature) — no need to manually drain



	CENTRIFUGAL AIR FILTERS		COALESCER
Part No.	HAF-502	HAF-503	HAF-505
Filtering Capacity	5 micron	5 micron	.01 micron
Flow Rate (CFM)	100 @ 90 psi	150 @ 90 psi	55 @ 90 psi
Max. Inlet Pressure	150 psi / 10.3 bar	150 psi / 10.3 bar	150 psi / 10.3 bar
Max. Operating Temp.	150°F / 65.6°C	150°F / 65.6°C	150°F / 65.6°C
Inlet Port Size	1/2" NPT (F)	3/4" NPT (F)	1/2" NPT (F)
Outlet Port Size	1/2" NPT (F)	3/4" NPT (F)	1/2" NPT (F)
Bowl Capacity	17 oz.	34 oz.	17 oz.
Shipping Weight	1 lb. 7 oz.	3 lbs. 1 oz.	1 lb. 8 oz.
Auto Drain	Std.	Std.	Std.
Service Bulletin	SB-6-146	SB-6-148	SB-6-152

CENTRIFUGAL FILTER-REGULATOR UNITS			
Part No.	HFRL-502	HFRL-509	HFRL-511
Filtering Capacity	5 micron	5 micron	5 micron
Flow Rate (CFM)	60+	80+	120+
Max. Inlet Pressure	150 psi / 10.3 bar	150 psi / 10.3 bar	150 psi / 10.3 bar
Regulated Pressure Range (psi)	0 - 125	0 - 125	0 - 125
Max. Operating Temp.	150°F / 65.6°C	150°F / 65.6°C	150°F / 65.6°C
Inlet Port Size	1/2" npt (f)	3/4" npt (f)	3/4" npt (f)
Regulated Outlets (w/ ball valve)	(1) 1/4" nps (m)	(2) 1/4" nps (m)	(4) 1/4" nps (m)
Non-Regulated Outlets (w/ ball valve)	(1) 1/4" nps (m)	(1) 1/4" nps (m)	(1) 1/4" nps (m)
Bowl Capacity	17 oz.	34 oz.	34 oz.
Air Filter Included	HAF-502	HAF-503	HAF-503
Quantity of Air Regulators/Model	(1) HAR-507	(1) HAR-507	(2) HAR-507
Air Gauges (0 - 100 psi)	1	1	2
Air Gauges (0 - 160 psi)	1	1	1
Shipping Weight	9 lbs.	15 lbs.	18 lbs.
Service Bulletin	SB-6-146	SB-6-148	SB-6-148

DeVilbiss FRC-650 All-In-One

Filter, Regulator and Coalescer

- FRC-650 All-In-One combines a filter, regulator and coalescer for shop air into one compact unit
- Four 1/4" nps (m) ball valves with unrestricted air passages, (three regulated plus one unregulated outlet)
- Automatic drains at each stage eliminate water build-up — no need to manually drain

FRC-650 Specifications:

- Type of Air Regulation: Diaphragm
- Air Inlet Port Size: 1/2" Pipe Thread-(1)
- Air Outlet Port Size: 1/4" nps (m)-(4)
- Max. Working Temperature: 170°F/80°C
- Max. Air Inlet Pressure: 175 psi (12.3 kgf/cm2)
- Regulated Outlet Pressure: 0-125 psi (0-8.8 kgf/cm2)
- Flow Rate: 100 cfm
- First Stage Filtering Capacity: 5 micron
- Second Stage Filtering Capacity: 1 micron
- Bowl and Body Construction: Aluminum
- Drain: Automatic



DeVilbiss CleanAir Three-Stage Desiccant Unit

Provides Clean Dry Filtered Air

- Ideally suited for low to medium production
- DAD-500 air-drying system includes three filtering units, as well as a wall mount bracket and a regulator with a gauge and ball valve
- Centrifugal and coalescer units include automatic bowl drain (standard feature) — no need to manually drain
- Coalescer filter includes filter change indicator
- Desiccant filter includes sight glass indicator (Changes color when desiccant needs replacement)



DAD-500* DESICCANT AIR DRYING SYSTEM	
Desiccant System Units	DAD-500 Air Drying System*
Air Inlet	1/2" NPT (F)
Air Outlet	1/2" NPT (F)
Max. Operating Pressure (psi)	150
Replacement Filters/Desiccant	DAD-1 [†]
Service Bulletin	SB-6-156
Air Flow Capacity (cfm)	25

*Includes HAF-502, HAF-505 and HAR-507 [†]Shipping Weight Approx. 10 lbs.

Low Pressure Air & Fluid Hose & Connections

Hose, Connections & Assemblies

Sizes Available		Bulk Hose Number	Maximum Working Pressure	Bend Radius	Std. Reel Length in Ft. 1 Piece Reels	Approx. Shipping Weight Based on Ft. Per Reel	Hose Weight Per 100 Ft.
i.d.	o.d.						
PREMIUM SPRAY FINISHING AIR BULK HOSE CHART – SMOOTH COVER							
1/4"	1/2"	71-10000	250 psi	2 3/4"	500	50 lbs.	10 lbs.
5/16"	5/8"	71-11000	250 psi	3"	500	87 lbs.	16.2 lbs.
3/8"	11/16"	71-12000	250 psi	3 1/2"	500	96 lbs.	18 lbs.
1/2"	7/8"	71-13000	250 psi	5"	300	86 lbs.	26.8 lbs.
3/4"	1 1/8"	71-14000	250 psi	6"	300	112 lbs.	35 lbs.
FLUIDALL™ FLUID BULK HOSE CHART (NYLON LINED, MAX. VERSATILITY) – SMOOTH COVER							
1/4"	1/2"	71-280	500 psi	3"	500	43 lbs.	8 lbs.
3/8"	11/16"	71-282	500 psi	3 1/2"	500	83 lbs.	15 lbs.
1/2"	7/8"	71-283	750 psi	5"	300	74 lbs.	22 lbs.
3/4"	1 3/16"	71-284	750 psi	8"	300	118 lbs.	36 lbs.
1"	1 1/2"	71-285	750 psi	12"	300	168 lbs.	53 lbs.



Type A. Plated Brass



Type B. Plated Brass



Type C. Plated Brass

CONNECTIONS FOR PREMIUM & STATIC WIRE AIR HOSE						
Hose Size		Bulk Hose No.	Connections		Compression Sleeve	Type
i.d.	o.d.		Thread	Part No.		
1/4"	1/2"	71-10000	1/4" nps(f)	72-1303	HC-20-K10	A
			3/8" nps(f)	72-1306	HC-20-K10	A
			3/8" nps(f)s.s.	72-2143*	72-854-5	A
5/16"	5/8"	71-11000 71-20000	1/4" nps(f)	72-1317	HC-12-K10	A
			1/4" npt(m)	72-1478	HC-12-K10	B
			3/8" nps(f)	72-1320	HC-12-K10	A
3/8"	11/16"	71-12000	1/4" nps(f)	72-1325	HC-23-K10	A
			3/8" nps(f)	72-1328	HC-23-K10	A
			3/8" nps(f)s.s.	72-2146*	72-854-5	A
1/2"	7/8"	71-13000	3/8" nps(f)	72-1333	HC-33	A
			1/2" nps(f)	72-1334	HC-33	A
			1/2" nps(f)	72-954†*	—	C
3/4"	1 3/16"	71-14000	3/4" nps(f)	72-1336†	—	C
			3/4" nps(f)	72-417†	—	C
			3/4" nps(f)	72-955†*	—	C
			3/4" nps(f)	72-1935	—	—
ERGOFLEX™ AIR HOSE CONNECTIONS						
3/8"	.646"	71-31000	1/4" nps(f)	72-2008	HC-12-K10	A

†Push-Lok Connection *Stainless Steel Tailpiece

CONNECTIONS FOR FLUIDALL™ FLUID HOSE						
Hose Size	Bulk	Connections		Compression Sleeve	Type	
i.d.	o.d.	Hose No.	Thread Part No.			
1/4"	1/2"	71-280	1/4" nps(f) 72-1303	HC-20-K10	A	
			3/8" nps(f) 72-1306	HC-20-K10	A	
			3/8" nps(f)s.s. 72-2143*	72-854-5	A	
3/8"	11/16"	71-282	1/4" nps(f) 72-1325	HC-23-K10	A	
			3/8" nps(f) 72-1328	HC-23-K10	A	
			3/8" nps(f)s.s. 72-2146*	72-856-5	A	
1/2"	7/8"	71-283	3/8" nps(f) 72-1333	HC-33	A	
			1/2" nps(f) 72-1334	HC-33	A	
			1/2" nps(f) 72-954*	—	C	
3/4"	1 3/16"	71-284	3/4" nps(f) 72-1336†	—	C	
			3/4" nps(f) 72-417†	—	C	
			3/4" nps(f) 72-955*	—	C	
			3/4" nps(f) 72-1935	—	—	
1"	1 1/2"	71-285	1" nps(f) 72-418†	—	C	
			1" nps(f) 72-956*	—	C	
			1" nps(f) 72-1936	—	—	

†Push-Lok Connection *Stainless Steel Tailpiece

HOSE ASSEMBLY SETS (AIR & FLUID)							
Part No.	Bulk Hose No.	Size	Max. Working Pressure	Tube Material	Connection Part No.	Threads	Connection Material
6-438	71-131	5/16" i.d. x 5/8" o.d. x 25 ft.	250 psi	Rubber	72-1317	1/4" nps (f) air	Brass Plated
	71-282	3/8" i.d. x 11/16" o.d. x 25 ft.	500 psi	Nylon	72-1328	3/8" nps (f) fluid	Brass Plated
KB-4006	71-131	5/16" i.d. x 5/8" o.d. x 5 ft. 9 in.	250 psi	Rubber	72-1317	1/4" nps (f) air	Brass Plated
	71-280	1/4" i.d. x 1/2" o.d. x 6 ft. 3 in.	500 psi	Nylon	72-1306	3/8" nps (f) fluid	Brass Plated

Low Pressure Air & Fluid Hose & Connections

Air Hose Assemblies

Premium spray finishing air hose designed for all finishing operations and applications requiring lubricants in the airline supply or where oil and grease are present. Excellent for use with water-based materials.

PREMIUM AIR HOSE ASSEMBLIES (LOW PRESSURE)							
Part No.	Bulk Hose No.	Size	Max. Working Pressure	Tube Material	Connection Part No.	Threads	Connection Material
71-1101	71-10000	1/4" i.d. x 1/2" o.d. x 5 ft.	250 psi	E.P.D.M.	72-1303	1/4" nps (f)	Brass Plated
71-1105	71-10000	1/4" i.d. x 1/2" o.d. x 25 ft.	250 psi	E.P.D.M.	72-1303	1/4" nps (f)	Brass Plated
71-1106	71-10000	1/4" i.d. x 1/2" o.d. x 50 ft.	250 psi	E.P.D.M.	72-1303	1/4" nps (f)	Brass Plated
71-1201	71-11000	5/16" i.d. x 5/8" o.d. x 5 ft.	250 psi	E.P.D.M.	72-1317	1/4" nps (f)	Brass Plated
71-1203	71-11000	5/16" i.d. x 5/8" o.d. x 15 ft.	250 psi	E.P.D.M.	72-1317	1/4" nps (f)	Brass Plated
71-1205	71-11000	5/16" i.d. x 5/8" o.d. x 25 ft.	250 psi	E.P.D.M.	72-1317	1/4" nps (f)	Brass Plated
71-1206	71-11000	5/16" i.d. x 5/8" o.d. x 50 ft.	250 psi	E.P.D.M.	72-1317	1/4" nps (f)	Brass Plated
71-1209	71-11000	5/16" i.d. x 5/8" o.d. x 6 ft.	250 psi	E.P.D.M.	72-1317	1/4" nps (f)	Brass Plated
71-1355	71-12000	3/8" i.d. x 11/16" o.d. x 25 ft.	250 psi	E.P.D.M.	72-1325	1/4" nps (f)	Brass Plated
71-1356	71-12000	3/8" i.d. x 11/16" o.d. x 50 ft.	250 psi	E.P.D.M.	72-1325	1/4" nps (f)	Brass Plated

Premium spray finishing air hose. Static wire in hose prevents build-up of static electricity. Used with air and electrostatic spray guns and equipment that require grounding for safety purposes.

AIR HOSE ASSEMBLIES (GROUNDED WITH STATIC WIRE)							
Part No.	Bulk Hose No.	Size	Max. Working Pressure	Tube Material	Connection Part No.	Threads	Connection Material
71-2803	71-20000	5/16" i.d. x 5/8" o.d. x 25 ft.	250 psi	E.P.D.M.	72-1317	1/4" nps (f)	Brass Plated
71-2810	71-20000	5/16" i.d. x 5/8" o.d. x 35 ft.	250 psi	E.P.D.M.	72-1317	1/4" nps (f)	Brass Plated
71-2804	71-20000	5/16" i.d. x 5/8" o.d. x 50 ft.	250 psi	E.P.D.M.	72-1317	1/4" nps (f)	Brass Plated

Ergonomically designed air hose with 40% less weight and more flexible than standard hose. Good for use with all kinds of air-operated equipment.

ERGOFLEX AIR HOSE ASSEMBLIES							
Part No.	Bulk Hose No.	Size	Max. Working Pressure	Tube Material	Connection Part No.	Threads	Connection Material
71-31101	H-3670	.390 i.d. x .650 o.d. x 25 ft.	200 psi	E.P.D.M.	72-2008	1/4" nps (f)	Brass Plated
71-31103	H-3670	.390 i.d. x .650 o.d. x 6 ft.	200 psi	E.P.D.M.	72-2008	1/4" nps (f)	Brass Plated

Fluid Hose Assemblies

Premium, versatile fluid hose for finishing operations plus a wide range of fluid applications. Ideal for epoxies, alkyds, primers, acrylics, polyesters, silicones, oil and water based paints, lacquers, alcohol and latex coatings.

FLUIDALL™ HOSE ASSEMBLIES (LOW PRESSURE)							
Part No.	Bulk Hose No.	Size	Max. Working Pressure	Tube Material	Connection Part No.	Threads	Connection Material
71-3260	71-280	1/4" i.d. x 1/2" o.d. x 5 ft.	500 psi	Nylon	72-1303	1/4" nps (f)	Brass Plated
71-3263	71-280	1/4" i.d. x 1/2" o.d. x 25 ft.	500 psi	Nylon	72-1303	1/4" nps (f)	Brass Plated
71-3279	71-280	1/4" i.d. x 1/2" o.d. x 9"	500 psi	Nylon	72-1303	1/4" nps (f)	Brass Plated
71-3380	71-280	1/4" i.d. x 1/2" o.d. x 5 ft.	500 psi	Nylon	72-1306	3/8" nps (f)	Brass Plated
71-3383	71-280	1/4" i.d. x 1/2" o.d. x 25 ft.	500 psi	Nylon	72-1306	3/8" nps (f)	Brass Plated
71-3384	71-280	1/4" i.d. x 1/2" o.d. x 50 ft.	500 psi	Nylon	72-1306	3/8" nps (f)	Brass Plated
71-3390	71-280	1/4" i.d. x 1/2" o.d. x 35 ft.	500 psi	Nylon	72-1306	3/8" nps (f)	Brass Plated
71-3663	71-280	1/4" i.d. x 1/2" o.d. x 25 ft.	500 psi	Nylon	72-2143	3/8" nps (f)	Stainless Steel
71-3300	71-282	3/8" i.d. x 11/16" o.d. x 5 ft.	500 psi	Nylon	72-1328	3/8" nps (f)	Brass Plated
71-3303	71-282	3/8" i.d. x 11/16" o.d. x 25 ft.	500 psi	Nylon	72-1328	3/8" nps (f)	Brass Plated
71-3304	71-282	3/8" i.d. x 11/16" o.d. x 50 ft.	500 psi	Nylon	72-1328	3/8" nps (f)	Brass Plated
71-3313	71-282	3/8" i.d. x 11/16" o.d. x 17"	500 psi	Nylon	72-1328	3/8" nps (f)	Brass Plated
71-3400	71-283	1/2" i.d. x 7/8" o.d. x 5 ft.	750 psi	Nylon	72-1334	1/2" nps (f)	Brass Plated
71-3403	71-283	1/2" i.d. x 7/8" o.d. x 25 ft.	750 psi	Nylon	72-1334	1/2" nps (f)	Brass Plated
71-3404	71-283	1/2" i.d. x 7/8" o.d. x 50 ft.	750 psi	Nylon	72-1334	1/2" nps (f)	Brass Plated
71-3360	71-285	1" i.d. x 1 1/2" o.d. x 5 ft.	750 psi	Nylon	72-1936	1" nps (f)	Brass Plated
71-3361	71-285	1" i.d. x 1 1/2" o.d. x 10 ft.	750 psi	Nylon	72-1936	1" nps (f)	Brass Plated
71-3367	71-285	1" i.d. x 1 1/2" o.d. x 8 ft.	750 psi	Nylon	72-1936	1" nps (f)	Brass Plated

E.P.D.M. = Ethylene Propylene Diene Rubber



Gun Extensions, Quick Disconnects & Lubricants

Gun Extensions

Nozzle extensions are designed to reach out of the way places, such as the inside of large and small diameter pipe. There are models for general use and for specific applications. Extensions are available for both air atomizing and airless spray guns.

Clearance Diameter (inches)	Nozzle Set-Up	Standard Lengths (inches)	For Gun Model	Part Sheet Reference (77-)
EA 1 3/4	Std. External or Internal Mix*	9, 15, 24, 36	2100, 95, 95A, 95AR	1368, 2659, 2660
EAX 7/8	External or Internal Mix*	◆	2100, 95, 95A	1369, 2659, 2660
EB 3	Std. External or Internal Mix*	6, 12, 15, 18, 24, ◆	2100, 21, 95, 95AR	1370, 2659, 2660
EBX 1 7/8	External or Internal Mix*	◆	2100, 95, 95A	1371, 2659, 2660
EN 2 1/2	Std. External or Internal Mix*	6, 12, 18, 36, 48, ◆	2100, 21, 95, 95A, 95AR	1372, 2659, 2660
ENX 1 3/4	External or Internal Mix*	◆	2100, 95, 95A	1373, 2659, 2660
ERX 1 7/8	External or Internal Mix*	◆	2100, 95, 95A	1374, 2659, 2660
C 3/4	Circular (360°)*	6, 12, 18, 24, 36, 48, 60, 72, 84, ◆ 12, 24, 36, 48, 60, 72, 84	2100, 21, 95, 95A, 95AR	1367, 2082, 2659, 2660
SC 3/8	Circular (360°)*	9, 12, 18, 27, 33, 39, 51, 63, 75, 87, ◆	2100, 21, 95, 95A	1328, 2659, 2660
SA 7/16	Round (Not Adjustable)	◆	2100, 95, 95A	1328, 2659, 2660
CVT 1 1/8	Same as for Models C and HC Except Nozzles have Tungsten Carbide Inserts*	◆	2100, 95, 95A	2083, 2659, 2660
HC 90°				
52-1382 1 3/8	Special for Pipe Interior Circular 360°	1/4" Pipe Not Included	Gun Not Required	—
52-2410 3/4	Circular 360°	5/16" I.D. Fluid Hose and Clamps Not Included	2100, 95	—

* See Extensions catalog EA52-100R for further detail on all extensions available

KEY CODE: ■ = High volume material flow.

◆ = Any length not shown made to order (custom).

◀ = Extension is available w/ stainless steel fluid nozzle having tungsten carbide insert.

Specify "VT" when ordering. See nozzle setup table.

Quick Disconnects

DEVILBISS HIGH FLOW AIR QUICK DISCONNECTS*			
Part No.	Description	Thread	
HC-1166	Hi-Flow QD Stem	1/4" npt (m)	
HC-4419	Hi-Flow QD Stem	1/4" npt (f)	
HC-4719	Hi-Flow QD Body	1/4" npt (m)	
HC-4720	Hi-Flow QD Body	1/4" npt (f)	

* Ideal for HVLP applications. See Accessories Catalog A28-100.

QUICK DISCONNECTS – BAYONETT STYLE (FLUID)					
Part No.	Type	Description	Max. Working Pressure	Connection	Service Form
Binks Style					
72-1804	Body (f)	Stainless Steel	500 psi	3/8" nps (m)	n/a
72-364	Stem (m)	Stainless Steel	500 psi	3/8" nps (f)	n/a
DeVilbiss Style					
P-HC-4808-1	Body (f)	Aluminum	500 psi	3/8" nps (m)	SB-12-001
P-HC-4482	Stem (m)	Hardened Steel	500 psi	3/8" nps (f)	SB-12-001
HC-513-1	Body (f)	Stainless Steel	500 psi	3/8" nps (m)	SB-12-001
QDL-4808	Body (f)	Delrin/Stainless	500 psi	3/8" nps (m)	SB-12-001
HC-4691	Stem (m)	Stainless Steel	500 psi	3/8" nps (f) Swivel	SB-12-001

BINKS QUICK DISCONNECTS (FLUID – SOLVENT BASED)					
Part No.	Type	Description	Max. Working Pressure	Connection	Service Form
72-885	Body (f)	Steel	250 psi	3/8" nps (m)	77-1759
72-887*	Stem (m)	Steel	250 psi	3/8" nps (f)	77-1759

* Replacement o-ring for stem: 20-3620-5 (5-pack Viton)

BINKS QUICK DISCONNECT ASSEMBLIES (FLUID – SOLVENT BASED)			
Part No.	Description	Max. Working Pressure	Service Form
72-888	72-885 Body, 72-887 Stem*	250 psi	77-1759

* Replacement o-ring for stem: 20-3620-5 (5-pack Viton)

Spray Gun & Pump Lubricants/Fluids

Part No.	Description
41-3134	Binks Pump Purge, Case of 12
41-4458-K	PTFE Grease (Magna Lube) .75 oz. Tube
44-285	14 oz. Grease Cartridge – Fits Standard Grease Guns
863009	Wet-Sol Upper Pump Packing Lubricant 1 Quart
42-175	Pump Packing Lubricant 1 Quart
863020	Air Line Lubricant 1 Quart
207-11155-1	Air Motor Lubricant 2 oz.
207-11155-2	Air Motor Lubricant 16 oz.
0114-009433	Pump Packing Lube For Solvent Based Materials, MX Series Pumps
0114-014871	Pump Packing Lube For Water Based Materials, MX Series Pumps
SSL-10-K12	DeVilbiss Gun Lube 12 ea 2 oz. Bottles
6-429	Binks Gunners Mate Gun Lube 20 ea 2 oz. Bottles

See Binks and DeVilbiss complete line of spray booth performance and safety products catalog A29-55 online at binks.com



Finishing Brands is the global manufacturing company focused on integrated total system solutions through the spraying, pumping, mixing, metering, and curing of a variety of coatings used in the transportation, general industrial, protective coating, wood, specialty and auto-refinish markets.

With a history spanning 350 years in combined experience, our equipment is designed and built to provide finishing solutions with long term value.

Customers involved in challenging finishing applications in particular, and the industrial marketplace overall, will benefit from Finishing Brands' advanced technology brands: DeVilbiss, Ransburg, BGK and Binks.

Sales and Service through our Global Network of Industrial Distributors

International Offices

Americas: **USA** ■ **Mexico** ■ **Brazil**
Europe/Asia/Africa: **United Kingdom** ■ **France** ■ **Germany**
Pacific Rim: **China** ■ **Japan** ■ **Australia**



DeVilbiss atomization
devilbiss.com



Ransburg electrostatics
ransburg.com



BGK curing and controls
bgk.com



Binks atomization and fluid handling
binks.com

Finishing Brands
finishingbrands.com

USA / Canada Toll Free Support
800-992-4657 Customer Support
888-992-4657 Technical Support



Finishing Brands.

A **CARLISLE** COMPANY